

WIND STAR

148-GUEST SAILING SHIP

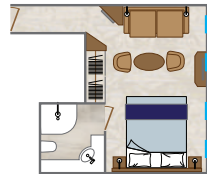

OWNER'S SUITE

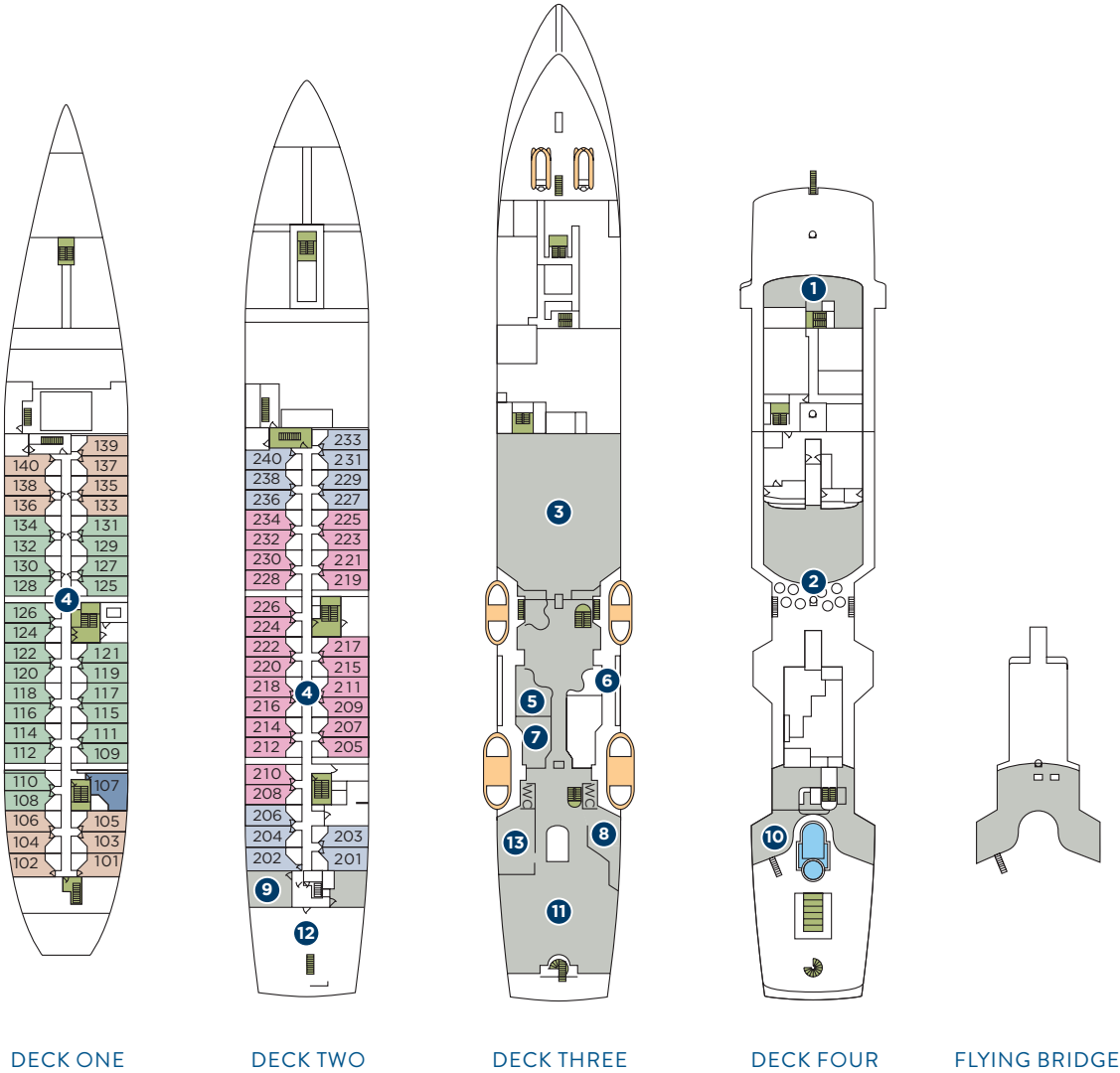
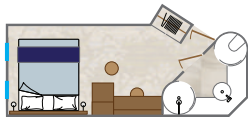

STATEROOM

STATEROOMS & SUITES

Owner's Suite:
220 square feet (21 square meters)
(Queen size bed only.
No twin option.)

Staterooms:
188 square feet (18 square meters)
(All staterooms except 101 and
102 have 3rd berths.)

**Staterooms with
Adjoining Private Doors:**
Wind Spirit: 124/126, 129/131,
132/134, 133/135, 136/138

Wind Star: 125/127, 128/130,
129/131, 132/134, 133/135,
136/138



Amphora



Owner's Suite



Stateroom



Lounge

ONBOARD SPACES

- | | | |
|----------------------|--------------------------------|-------------------------|
| 1 Bridge | 6 Reception | 11 Lounge |
| 2 Veranda/Candles | 7 Library | 12 Watersports Platform |
| 3 Amphora Restaurant | 8 World Spa by Windstar | 13 Yacht Club Café |
| 4 Staterooms | 9 Fitness Center | |
| 5 Star Boutique | 10 Pool / Pool Bar / Whirlpool | |

- Owner's Suite
- Category AX Deluxe
- Category A
- Category BX Deluxe
- Category B
- Public Spaces
- Stairs

SHIP FACTS

GUEST CAPACITY: 148
GUEST DECKS: 4
CREW MEMBERS: 101
LENGTH: 360 feet (110 meters)
at waterline; 440 feet (134 meters)
including bowsprit
DRAFT: 14 feet (4.1 meters)
TONNAGE:
Wind Spirit: 5,736 gross
registered tons (grt)
Wind Star: 5,307 gross
registered tons (grt)
BEAM: 52.1 feet (15.8 meters)

SAILS: 6 triangular, self-furling,
bridge-operated sails with 21,500
square feet (2,200 square meters)
of Dacron surface area
MASTS: 4 at 204 feet (62 meters)
ENGINES: 3 diesel electric generator
sets, 1 electrical propulsion motor
SPEED: 10 knots with engines only;
up to 15.8 knots with prevailing wind
SHIP'S REGISTRY: Bahamas



Wind Star

- Access to board ship is via stairs only.
- Access to/from outside deck may require assistance with doors and thresholds.