

# Worldwide cultural expeditions

2021/2022 sailings



# Contents

4	The Swan Hellenic Difference	20	Sustainability
6	Cultural Cruising	22	Antartica
8	Our Ships	38	The Arctic
10	Staterooms & Suites	58	Russian Far East
12	Personal Service	76	Rest of the world
13	Dining	108	Deck Plans
14	Life onboard	110	Itinerary Summary
16	Life on land – excursions	111	Terms & Conditions
18	What's included	115	Contact Us

Sunrise over the black sand beach, Vik, Iceland



# A legacy of discovery. A future of possibility.

Swan Hellenic has always been a pioneering company. For over 70 years, we've been known for creating unique, cultural expedition cruises for those who want to explore more, and dive a little deeper. The world may have changed a great deal in that time, but our passion for adventure and cultural exploration has only grown stronger.

Today, we're more ambitious than ever. We sail to places unreachable by others, seek immersive experiences, and make life-changing discoveries with every journey.

We're proud to launch three new state-of-the-art expedition ships. The epitome of travel excellence, these boutique ships are designed with a focus on wellness, with spacious, light-filled rooms and stunning panoramic views that bring you closer to nature.

Let us take you to places where the earth's mysteries still hold untold wonders. From the vast, polar regions to the Russian Far East and beyond, there's so much more to explore. With us, you'll see what others don't.

We look forward to welcoming you on board.

## THE SWAN HELLENIC DIFFERENCE

# See what others don't

Some people see things as they are, others look further. Let us take you on a journey, that will change the way you see the world. Sail to some of the most incredible, remote destinations on the planet, When you travel with us, the wonders of the world take on a richer hue.





Arctic fox

### Over 70 years of cruise expertise

That's how long we've been navigating the world's waters. Swan Hellenic is built on a passion for exploration, a reputation for safety and professionalism of the highest standard.

### Boutique ships

Just you and nature, that's how you'll feel on our 5 star contemporary Scandinavian inspired ships. With open-plan design, panoramic views and a focus on wellness, they're the perfect place to relax, recharge and explore.

### Intuitive service

When it comes to anticipating your needs, no request is too big or too small. To us, personal and unobtrusive service means everything from making sure you're fully equipped for an Arctic excursion to remembering your favourite gin serve when it comes to pre-dinner drinks.

### Enriching cultural expeditions

Once, we travelled to educate – professors, scientists, researchers. Over the years, we've developed a deep knowledge of the world. Today, we use this knowledge to create immersive cultural experiences that take you to the heart of a place.

## CULTURAL CRUISING

# Exploring with head and heart

Swan Hellenic pioneered cultural expedition cruising in 1954, when we took members of the Hellenic Society around the famous sites of ancient Greece in the company of eminent classicists.

Sea Turtle





Every Swan Hellenic cruise is the same today, combining geographical exploration with cultural and scientific discovery. We don't just take you to explore the most extraordinary places on earth. We bring you the company of like-minded people and renowned experts, who offer eye-opening lectures and are on hand for informal questions and discussion throughout your cruise.

So when you choose Swan Hellenic to see what others don't – you can be sure you'll do so with a full perspective and real insight into the history, cultures, wildlife, flora, geology and geography of the place. Briefings before each disembarkation and recaps afterwards supplement our lectures and talks, stimulating a relaxed social environment that encourages the sharing of experiences.



At the same time, every Swan Hellenic cruise is also full of opportunities for you to develop your creative passions, with professionals on board to support you in photography and more. A library completes the picture, with a multitude of books on every subject, for you to take your interests to another level.

It's the depth of these other dimensions that's unique to Swan Hellenic, making us the first choice of adventurous minds worldwide.



## OUR SHIPS

# A new class of exploration

Spacious, yet intimate. Panoramic views. Scandinavian design. At one with nature. This is boutique cruising at its finest.

Our brand-new, 5-star ships are designed to journey off the beaten path in unparalleled style. With elegant Scandi-design interiors, extensive outdoor spaces, and dedicated expedition facilities, these ships offer complete comfort and elegance. From our astonishing panoramic sauna and outdoor hot tub, and the stunning Swan Restaurant, to the understated elegance of your stateroom or suite – our ships have everything you need for a remarkable travel experience, all designed to make the most of the unparalleled views, so that you can see what others don't. Advanced features make the most of the incredible destinations we sail to, including an ice-strengthened hull and extra-large stabilisers for the smoothest of journeys.

Our first ship, SH Minerva arrives in November 2021, with a further two ships setting sail in April and November 2022.

Rendering of SH Minerva

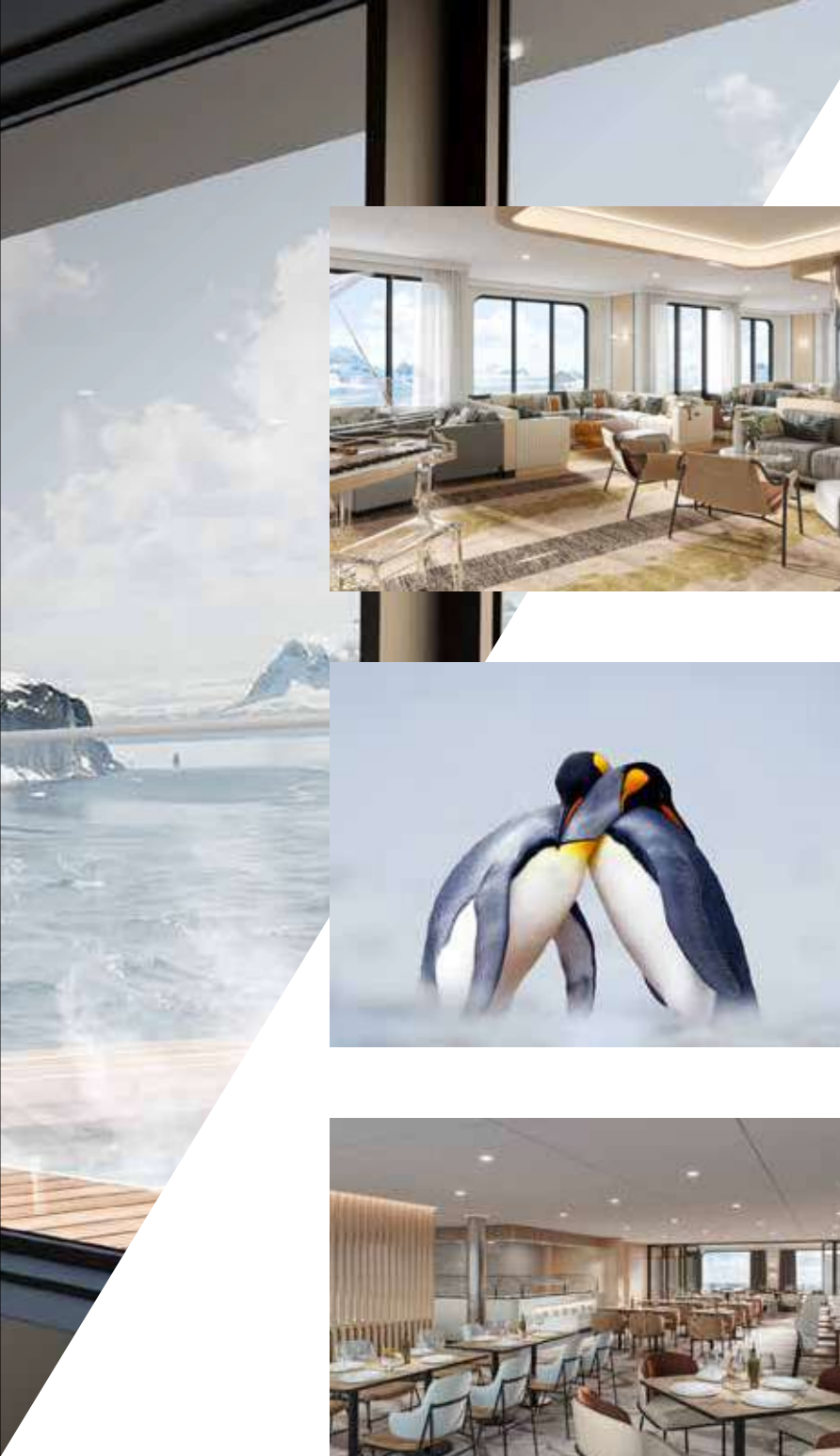

### Bringing nature to you

Our ships help you immerse yourself in inspiring landscapes. With dramatic picture windows in our Restaurant and lounges, accompanied by plush sofas and easy chairs – and a wide variety of indoor and outdoor areas – you'll always be able to find the perfect spot.

### Expedition expertise

The Swan Hellenic brand has always been known for combining bold, intriguing itineraries with expert academic lecturers and a sophisticated on board experience. This compelling mix of cultured luxury and trailblazing experiences will inspire and excite you, as you enjoy an unforgettable journey of discovery.

### Dining

At The Swan Restaurant, every meal is exquisitely served: our chefs specialise in getting the best out of quality regional ingredients. For a more relaxed get-together, there's The Club Lounge – fresh tapas-inspired cuisine is served alongside ocean views, 24 hours a day.

### Relax and unwind

After your onshore activities, treat yourself to some pampering and relaxation onboard. Mellow in our heated infinity pool and lap up the views from the extensive outside decks. Enjoy an indulgent massage, or take a sauna or outdoor hot tub with panoramic arctic views.



## STATEROOMS &amp; SUITES

# Retreat into sophisticated elegance

Relax in the understated elegance of your stateroom or suite, a modern medley of pastel colours, natural textures, hi-tech entertainment and multiple lighting options for every mood, set off by a holographic fireplace to warm the atmosphere. Large windows or floor-to-ceiling balcony doors showcase every incredible landscape as you sail serenely by.

## Your perfect space

Each of our 76 beautifully designed staterooms has everything you need for a pampered stay. Fluffy dressing gowns, a spacious dressing area and ample seating, as well as a well-stocked minibar and a personal safe. The desk in your room is the perfect place to plan the next day's adventures, and glass-enclosed rain showers transform your en suite into a personal spa.



### Premium Suite

49m<sup>2</sup> (528 ft<sup>2</sup>) | Sleeps 4

Premium suites feature a superking bed and separate living room with a soothing flame-effect fireplace a luxurious ensuite bathroom with separate bath tub and walk in shower, spacious walk in wardrobe and a 12m<sup>2</sup> (129ft<sup>2</sup>) private balcony.



### Suite

44m<sup>2</sup> (474 ft<sup>2</sup>) | Sleeps 4

Suites feature a superking bed and separate living room with a soothing flame-effect fireplace, a luxurious ensuite bathroom with separate bath tub and walk in shower and a 12m<sup>2</sup> (129ft<sup>2</sup>) private balcony.





Sun set on the balcony



### Balcony

28m<sup>2</sup> (302 ft<sup>2</sup>) | Sleeps 2/3

Balcony staterooms feature 2 single beds or a double bed bedroom with living room area, a luxurious bathroom and your own private 6m<sup>2</sup> (65ft<sup>2</sup>) balcony.



### Oceanview

19m<sup>2</sup> (205 ft<sup>2</sup>) | Sleeps 2

Oceanview staterooms feature 2 single beds or a double bed with living room area and a luxurious bathroom.

## PERSONAL SERVICE

# It's all in the details

Swan Hellenic is all about personal service and genuine hospitality. Our warm and welcoming crew aim to please and want nothing more than to give you the best experience possible.

No task is too big or too small: need a double espresso to get you going in the morning? Noted. Prefer your bed made up a certain way? We'll look after it. Absorbed by the views or the conversation at dinner? We'll take care of everything else. We've been in the business a long time and take pride in our caring, thoughtful approach. If there's anything we can do to improve your time on board, let us know.

Dining in The Swan Restaurant



# Perfectly paired with adventure

No travel experience is complete without unforgettable dining.

Whether you're sharing a table with new-found friends at The Swan Restaurant, enjoying a few late-night drinks at the Club Lounge or taking advantage of our 24-hour room service, every taste adds to the story. No matter the time of day, you'll find gastronomic excellence prepared by world-renowned chefs, and personal service to match.



Dining in The Swan Restaurant

## Chef's Table

The Swan Restaurant's private dining experience. Enjoy a tailor-made menu from our executive chef, with wine pairing from our sommelier. A brief, expert explanation of each pairing elevates the dining experience and leaves you with a deeper gastronomic knowledge of the destinations we visit.

## Club Lounge

Vibrant and welcoming, the Club Lounge acts as a hub for relaxed get-togethers onboard, 24 hours a day. Freshly baked pastries and coffee, tapas-style dining and freshly made pizza are the perfect accompaniment to signature craft cocktails and a panoramic view of the ocean glittering below from the adjoining Pool Bar & Grill.

## Afternoon Tea

Enjoy a British tradition onboard. Our afternoon tea is a glamorous and contemporary progression of savoury bites, finger sandwiches and scones followed by colourful tarts and desserts – all paired with a selection of international teas or a cold glass of champagne.

## Room Service

No matter what time of day, our carefully curated in-room menu gives you a world-class gastronomic experience in the comfort of your own stateroom. From healthy breakfasts, luscious lunches and divine dinners to late-night snacks, there's always something ready to tempt you.



## LIFE ON BOARD

# Every moment has its choice

Our cultural expedition cruises are really quite unique.

So, we'd like to give you a brief idea of a typical day aboard. Except we can't. Because there's no such thing as a typical day with Swan Hellenic. We can merely outline the possibilities that allow you to tailor every moment to your interests and mood, even if that simply involves rising late to breakfast in bed, or standing over the prow in the Swan's Nest late at night, musing out to sea.



**2** You'll be briefed on any technical aspects of your day before setting off in small groups – each with its own expert guide. Options range from kayaking to expeditions in zodiacs, from snorkelling or exploring the coast, to landing ashore for hiking, discovering areas of outstanding interest and beauty.

So, here it is. A day of typical choices.

**1** Waking comfortably refreshed to the natural textures and panoramic views of your stateroom, breakfast is just a short walk away. Choose from a light continental through to a substantial cooked breakfast as fuel for an action-packed day. Drink in the view while the calories and caffeine kick in, before making your way down to Basecamp – our Concierge-managed full-service changing room, where you kit up for your expeditions.



**3** Back on board, changing and chatting over a coffee in Basecamp as the attendants take care of your kit, you'll have the time to compare impressions and share experiences before lunch, whether snacking in the Club Lounge or savouring something more substantial or even sumptuous in the restaurant.



**5** Soon it will be time for the daily recap and any briefing for tomorrow's expeditions. And then it's on to the pleasures of elegant but informal dining, followed by a piano performance, board game, cards or outdoor wildlife observation and stargazing under crystal clear skies. And with all that to float your boat, you'll ease happily into your supportive mattress at the end of the day, with a great night's sleep assured.



**4** The afternoon offers the opportunity of an expert lecture on the area, followed by further expeditions or excursions. Or you might want to explore a passion like philosophy, poetry or photography, supported and inspired by an expert professional. Or, of course, you could lounge on our extensive decks, immersed in the astounding seascapes and wildlife. Or you could grab a towel, sit back and sweat it out, admiring every aspect from inside the panoramic sauna – relaxing, regenerating and detoxing before a soothing massage. Or you could visit the gym or the hairdresser or shop for essentials. Or you could borrow a new book from the library to read in the comfort of your stateroom, listening to music of your choice over the quality sound system. Or you could watch an HD movie on the big flatscreen TV. Or you could experience a personal visit to the ship's bridge to see behind the scenes.



As you can see, while a Swan Hellenic cultural expedition cruise may be a world away from the noisy glitz and crowds of the mass market, you'll never be short of choices to stimulate body and mind. With us, you'll truly see what others don't.



## LIFE ON LAND

# Awaken your inner explorer

Exploratory travel is in our DNA, which is why our team of expedition leaders are focused on giving you the most authentic experience possible when you step onshore. And when it comes to researching our shore excursion programmes, we leave no stone unturned. Each innovative itinerary is carefully planned and executed by world-class experts – from exploring the rugged terrain of Franz Josef Land, to discovering the rich cultures of the many orthodox communities along the Siberian Yenisei river.

Typical zodiac excursion



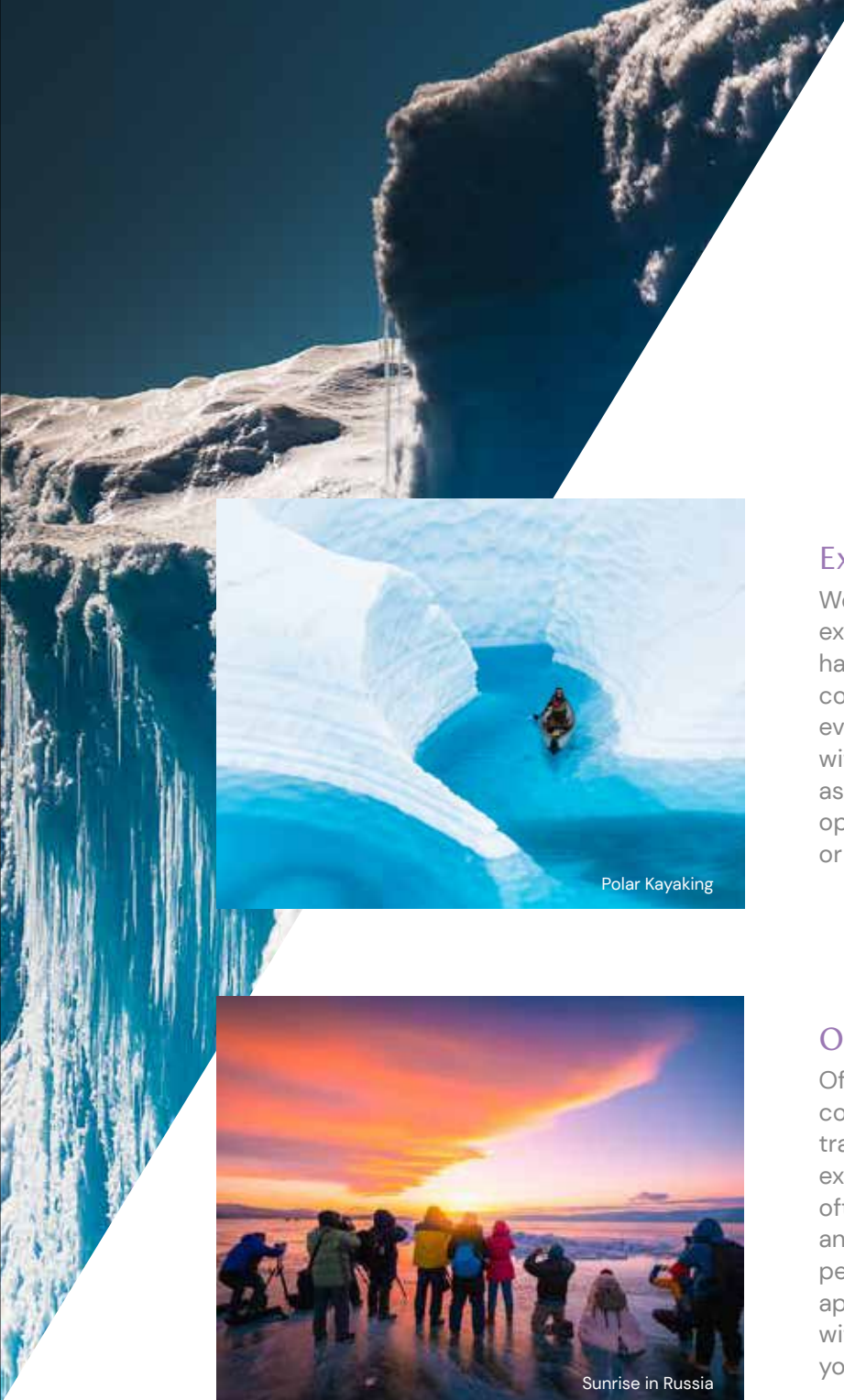

Polar Kayaking



Sunrise in Russia



Concierge-managed  
changing room

## Exploration for everyone

We strongly believe in creating incredible experiences for every guest. Our Zodiacs have been designed for increased comfort and manoeuvrability so that everyone can get up close and personal with their majestic surroundings. As well as our daily zodiac excursions there are opportunities for polar kayaking, trekking, or even a refreshing Polar plunge.

## Our local perspective

Often, it's the people you meet and the connections you make that transform travel into something more. We value local expertise, so when you sail with us you'll often experience a destination's culture and history through the guidance of the people who live there. This people-focused approach to travel is incredibly satisfying, with immersive cultural experiences giving you a taste of life in far-flung places.

## Basecamp

For a perfect excursion experience from start to finish, we created Basecamp – our heated, concierge-managed changing room, where our team will take care of cleaning and sanitising your expedition outfit. It's also a place to socialise over coffee before and after expeditions, relaxing in a signature décor of airy natural textures and tones.

## MAKING TRAVEL EFFORTLESS

# What's included

When the details are taken care of, you can focus on making the most of your expedition. So we've included all the little details in the price of your cruise fare. No hidden extras or surprise gratuity bills at the end of your holiday — you can be comfortable we've thought of the little things, so you don't have to.

Whats included	Cruising to		
	Antarctica	Arctic & Russian Far East	Rest of the World
One night pre-cruise accommodation with breakfast in a 4/5* hotel or onboard	✓	✓	✓
All transfers between the hotel, port and airport	✓	✓	✓
All meals onboard	✓	✓	✓
Room service 24 hours a day	✓	✓	✓
Coffee, tea, soft drinks and selected alcoholic beverages 24 hours a day	✓	✓	✓
Lecture programmes by our experienced expedition team and guest speakers	✓	✓	✓
Standard WiFi*	✓	✓	✓
Onboard gratuities and port taxes	✓	✓	✓
One shore excursion per port of call	✓	✓	✓
Branded Swan Hellenic expedition parka	✓	✓	
Use of rubber boots for shore landings	✓	✓	
Return flights for Antarctic cruises from Buenos Aires to Ushuaia or Santiago to Ushuaia	✓		

\*Standard WiFi is included in the cost of your cruise. Premium WiFi is also available onboard for a fee.





Beverages served daily



## Enhance your experience

We also offer some optional extras that are not included in the price of your holiday:

- Air fares (unless otherwise stated)
- Travel insurance
- Any Visa requirements
- Optional additional nights pre or post cruise
- Meals on shore
- Private zodiac tours
- Premium alcoholic beverages
- Spa & beauty treatments
- Laundry services
- Retail shop purchases
- Premium shore excursions outside of the polar regions (unless otherwise stated)



## SUSTAINABILITY

# A question of care

With decades exploring the landmark sites of human creativity and the unspoilt wildernesses of our beautiful planet, it's only natural we care passionately about preserving their wonders for future generations. This spirit of care is shared by the like-minded people who explore with us. We are in every sense fellow travellers. Which is why we care for you as we would hope to be cared for ourselves.

Shepard's delight



## Caring for the environment

- We are fully compliant with the International Maritime Organization's MARPOL convention on the prevention of pollution at sea, which is stricter than most local laws and regulations.
- We also go beyond them in adopting all the additional voluntary standards of the Cruise Lines International Association, in particular with respect to grey water discharge.
- The above two combined cover all types of waste and emissions (solid waste, water, air and chemicals etc), reflected in on-board recycling and high energy efficiency solutions, including the use of biodegradable detergents and Advanced Waste Water Treatment systems.





- Complimentary metal water bottles are provided for all guests.
- Single-use plastics are reduced to an unavoidable bare minimum on board, including for in-cabin toiletries and drinking straws. We make every effort to continually reduce this still further.
- Our crews and staff follow strict procedures to minimise the environmental footprint wherever we visit.
- We have a paperless policy and where unavoidable aim to print on recycled paper.
- Our ships all feature Tier III diesel electric generation with Selective Catalytic Reduction units to reduce harmful emissions.
- Battery power is used for quiet, emission-free navigation in port and sensitive wildlife areas.
- Dynamic positioning systems mean our ships can avoid dropping anchor in fragile environments, preventing damage to delicate ecosystems.
- Advanced potable water treatment systems mineralise and carbonate freshly-prepared pure drinking water, eliminating the need for bottled water.



### Caring for our guests

- Our ships are all built with the latest hygiene technology and standards in consultation with world-leading onboard hygiene experts Vikand.
- All our onboard air conditioning systems are UV sanitised using the most advanced technology.
- Our booking policy provides complete peace of mind and full protection to guests.



# Antarctica. Or the footsteps of explorers past?

**Size**

14.2 million square km

**Key wildlife**

Penguins, blue whales,  
seals, orcas, albatross

**When we sail**

November–February

Antarctica. There really is no other place like it. The ice-blanketed landscape once explored by legends like Shackleton and Amundsen has an otherworldly allure. Panoramic views afforded from our ships make appreciating its beauty – and spotting penguins and whales in its waters – a unforgettable experience. What wonders will you discover in the vast reaches of this unique destination?





# Antarctic Solar Eclipse

SOUTH ORKNEY & ANTARCTIC PENINSULA

What's more magical than sailing through Antarctica's polar wilderness, penguin-spotting and whale-watching the day away? Doing it during a rare solar eclipse.

## Sailing on

30th November 2021

## Returns on

11th December 2021

## Duration

12 days

## Sailing from

• Ushuaia, Argentina

## Sailing to

• Ushuaia, Argentina

## Ship

SH Minerva

Zodiac in front of enormous iceberg

Dream big on this epic 12-day voyage. This once-in-a-lifetime cruise is timed so you can experience the unforgettable Solar Eclipse 2021 with the backdrop of a mesmerising icy landscape. Beaches bursting with penguins will stir the emotions as you get up close for fabulous photo opportunities. Taking time to fully explore the South Orkney Islands and visiting the volcanic landscape of the South Shetland Islands, your bucket-list-worthy luxury cruise is the ultimate Antarctica trip.

Day	Visiting
1	Ushuaia, Argentina
2,3	At Sea
4	South Orkney Islands
5	Solar Eclipse 62S 42W
6-8	Antarctic Peninsula
9	South Shetland Islands, Antarctica
10,11	At Sea
12	Ushuaia, Argentina

Itineraries are correct at time of going to print and maybe subject to change.



Humpback Whale diving



Solar Eclipse



## ARGENTINA

### Ushuaia



#### USHUAIA

The mountainous landscapes of this pedestrianized town rise up around the bustling sea harbor.



#### SOUTH ORKNEY ISLANDS

This Scottish archipelago offers plenty of opportunities to see seabirds, whales and penguins in their natural habitat.

#### DRAKE PASSAGE

### Elephant Island

### South Orkney Islands

### South Shetland Islands



#### SOUTH SHETLAND ISLANDS

As you reach the coast in the Zodiac, take in the unique local flora that sprawls across the stunning volcanic landscape.

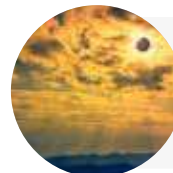

#### SOLAR ECLIPSE AT SEA

Cruise through Antarctica's incredible landscape under a slowly darkening sun. Spellbinding.

## ANTARCTIC PENINSULA



#### DAY AT SEA

Learn more about this extraordinary icy wilderness from our expert team of polar specialists and photographers

# Classic Antarctica

## ANTARCTIC PENINSULA

A journey like no other. From the shores of South America to epic icy landscapes and the unique Shetland Islands, this life-affirming adventure takes you to unimaginably beautiful locations teeming with wildlife.

**Sailing on**

12th December 2021

**Returns on**

21st December 2021

**Duration**

10 days

**Sailing from**

● Ushuaia, Argentina

**Sailing to**

● Ushuaia, Argentina

**Ship**

SH Minerva

Seals on an iceberg





Experience the epic landscapes and phenomenal wildlife found near the Earth's southernmost point. This voyage takes you across Drake Passage straight to the frozen Antarctic Peninsula – where you'll discover mesmerising icy wonders like the Gerlache Strait and exceptionally beautiful Antarctic Sound. Step ashore and get up close and personal with the local penguins for that perfect photo opportunity, before sailing on to the South Shetland Islands.

Day	Visiting
1	Ushuaia, Argentina
2,3	At Sea
4	Antarctic Sound
5,6	Antarctic Peninsula
7	South Shetland Islands
8,9	At Sea
10	Ushuaia, Argentina

Itineraries are correct at time of going to print and maybe subject to change.



# Antarctica in Depth

ANTARCTICA, SOUTH GEORGIA & FALKLANDS

This 16-day sailing visits some of the remotest destinations in the world – and will leave you with a deeper understanding and appreciation of nature's vast beauty. Journey alongside polar specialists and share in their vast knowledge of these isolated regions. Combine the adventure with days spent relaxing on board for the trip of a lifetime.

**Sailing on**  
22nd December 2021

**Sailing from**  
• Ushuaia, Argentina

**Returns on**  
6th January 2022

**Sailing to**  
• Ushuaia, Argentina

**Duration**  
16 days

**Ship**  
SH Minerva

It's time to live out your Antarctic dream on this exceptional voyage. Your journey through this icy wilderness begins with a two-day Drake Passage sea crossing. Then we sail to the Falklands, and follow in the footsteps of legendary explorer Ernest Shackleton by visiting South Georgia. In both those stunning destinations, you'll get up close to local wildlife – experiencing rare moments that every polar explorer treasures. Magnificent icebergs tower overhead as we sail around the Antarctic Peninsula on this fully immersive cruise.

Day	Visiting
1	Ushuaia, Argentina
2	At Sea
3	Grave Cove & New Island
4,5	At Sea
6,7	South Georgia
8,9	At Sea
10	Elephant Island
11,12	Antarctic Peninsula
13	South Shetland Islands
14,15	At Sea
16	Ushuaia

Itineraries are correct at time of going to print and maybe subject to change.



St Andrews beach, South Georgia



Abandoned Whaling Ship, South Georgia





Antarctica glacier



Whale-spotting in their natural habitat



Lazy seal on Elephant Island





# Falklands & Antarctic Peninsula

## ROUND TRIP FROM USHUAIA

Few travellers experience island life like this. Discover the hidden beaches and rugged cliffs of the Falklands and South Shetland Islands – breathtaking landscapes that will stay in your memory forever.

### Sailing on

7th January 2022 &  
8th February 2022\*

### Returns on

19th January 2022 &  
20th February 2022

### Duration

13 days

### Sailing from

● [Ushuaia, Argentina](#)

### Sailing to

● [Ushuaia, Argentina](#)

### Ship

SH Minerva

Shoreline of Falkland Islands



Follow in the footsteps of Polar explorers as you witness the remote beauty of these regions. Visit the island communities of the Falklands and the unique flora and fauna of the South Shetland Islands. Cross the Drake Passage to reach Antarctic waters, where breaching minke and humpback whales swim gracefully between magnificent icebergs. Breathe in the icy air, and awaken your inner adventurer.

Day	Visiting
1	Ushuaia, Argentina
2	At Sea
3	New Island & West Point Island, Falkland Islands
4	Port Stanley, Falkland Islands
5	At Sea
6	Elephant Island, Antarctica
7-9	Antarctica Peninsula
10	South Shetland Islands, Antarctica
11,12	At Sea
13	Ushuaia, Argentina

\*The sailing on 8th February is a 13 day sailing, which spends additional time sailing around the stunning Antarctic Peninsula.  
Itineraries are correct at time of going to print and maybe subject to change.



Port Stanley, Falkland Islands



Beautiful ice sculptures



# Antarctica Encompassed

## ANTARCTIC PENINSULA

This 11-day sailing visits incredible beaches crammed with penguins for the most fabulous photo opportunities. Fulfil your dreams on this bucket-list cruise, and experience epic landscapes and phenomenal wildlife on a life-changing adventure.

**Sailing on**

19th January 2022,  
29th January 2022\*

**Returns on**

29th January 2022 &  
8th February 2022

**Duration**

11 days

**Sailing from**

• [Ushuaia, Argentina](#)

**Sailing to**

• [Ushuaia, Argentina](#)

**Ship**

SH Minerva

Antarctic mountain range





This voyage takes you across the notorious Drake Passage straight to the frozen Antarctic Peninsula where you discover mesmerising icy scenes of both the Gerlache Strait and exceptionally beautiful Antarctic Sound. This unforgettable journey will leave you with remarkable tales of how you achieved your life goal by visiting one of the most remote places on the planet.



Day	Visiting
1	Ushuaia, Argentina
2,3	At Sea
4	Antarctic Sound
5-7	Antarctic Peninsula
8	South Shetland Islands
9,10	At Sea
11	Ushuaia, Argentina

\*The sailing on 29th January is an 11 day sailing, with slight variation in the length of time spent in each destination.  
Itineraries are correct at time of going to print and maybe subject to change.

# Shackleton's Discovery

ANTARCTICA, SOUTH GEORGIA & THE FALKLANDS

Dream big on the epic 22-day Shackleton's Antarctic Discovery cruise on board our boutique ship that takes you places you will never forget. Our trip also includes the two-day sea crossing of the notorious Drake Passage.

**Sailing on**  
16th November 2022

**Returns on**  
7th December 2022

**Duration**  
22 days

**Sailing from**  
• Buenos Aires, Argentina

**Sailing to**  
• Ushuaia, Argentina

**Ship**  
SH Vega

Elephant Island

Taking in the sights of the Falkland Islands, as well as South Georgia and Elephant Island, you will visit beaches crammed with penguins which are sure to stir your emotions. Magnificent icebergs provide a phenomenal backdrop to days at sea, and the exceptional landscape and wildlife encounters make this voyage the ultimate Antarctica trip.

Day	Visiting
1	Buenos Aires, Argentina
2,3	At Sea
4	Puerto Madryn, Argentina
5,6	At Sea
7	West Point Island & Saunders Island, Falkland Islands
8	Port Stanley, Falkland Islands
9,10	At Sea
11-13	South Georgia
14,15	At Sea
16	Elephant Island, Antarctica
17,18	Antarctic Peninsula
19	South Shetland Islands, Antarctica
20,21	At Sea
22	Ushuaia, Argentina

Itineraries are correct at time of going to print and maybe subject to change.



Saunders Island at sunset



Macaroni Penguins



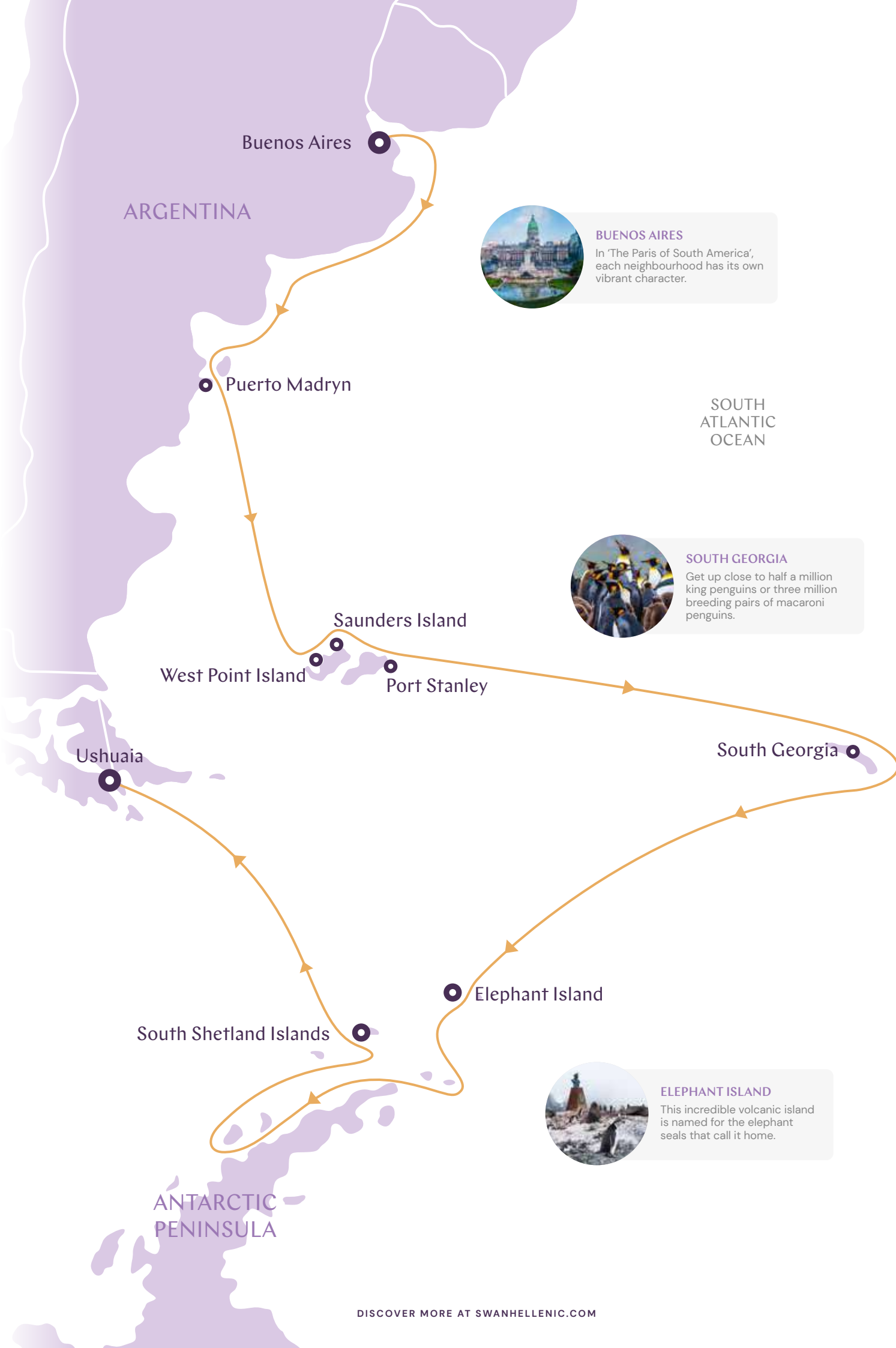

ARGENTINA

Buenos Aires



**BUENOS AIRES**

In 'The Paris of South America', each neighbourhood has its own vibrant character.

SOUTH ATLANTIC OCEAN



**SOUTH GEORGIA**

Get up close to half a million king penguins or three million breeding pairs of macaroni penguins.

Saunders Island

West Point Island

Port Stanley

Ushuaia

South Georgia

Elephant Island

South Shetland Islands



**ELEPHANT ISLAND**

This incredible volcanic island is named for the elephant seals that call it home.

ANTARCTIC PENINSULA

# The Arctic. Or the achievement of a lifetime?

## Size

20 million square km

## Largest cities

Murmansk, Norilsk, Tromsø

## When we sail

May – September

A destination as life-changing as the Arctic means more than just a point on a map. As you glide past glistening ice, you'll spot seals rolling in the waves and polar bears lumbering across the horizon. As night falls, gaze upon a sky like nothing you've ever seen before. Discovering the untouched pinnacle of the Earth is a truly momentous achievement.





# Iceland Circumnavigation

Experience the land of fire and ice like never before. The views from the ship over this geologically active island are vast and otherworldly. On shore, soak in geothermal pools and explore on remote wildlife-spotting treks.

## Sailing on

16th May 2022

## Returns on

23rd May 2022

## Duration

8 days

## Sailing from

● Reykjavik, Iceland

## Sailing to

● Reykjavik, Iceland

## Ship

SH Vega

## GREENLAND

In far-flung icy waters, watch for breaching humpback and orca whales as you circumnavigate Iceland's spectacular volcanic landscape. Our team of experts will lead you on a journey of discovery, from the puffin-spotting capital of the world Heimaey Island, to the thunderous roar of Dynjandi waterfall. The hidden secrets of this remote, magical environment are truly awe-inspiring.

Day	Visiting
1	Reykjavik, Iceland
2	Heimaey, Iceland
3	Vik, Iceland
4	Eskifjordur, Iceland
5	Akureyri, Iceland
6	Isafjordur / Vigur Island, Iceland
7	Dynjandi, Iceland
8	Reykjavik, Iceland

Itineraries are correct at time of going to print and maybe subject to change.





Green inland of Iceland



#### DYNJANDI

Listen to the thunderous roar of Dynjandi waterfall and cruise along remote fjords.



#### AKUREYRI

Known for its colourful old town, heart-shaped traffic lights and woodlands.



#### ESKIFJÖRÐUR

Taste living history in local dishes prepared at Randulfssjóhus (Randulf Seahouse).



#### REYKJAVIK

Explore cosy bars, cafes and shops on streets heated by geothermal waters.



#### HEIMAEY

Ten million Atlantic puffins make Heimaey Island the world's largest puffin colony.

NORWEGIAN SEA

NORTH ATLANTIC OCEAN



# Arctic Discovery

ICELAND, JAN MAYEN & SPITSBERGEN

A journey through the Greenland Sea is filled with rare discoveries. From rarely-visited volcanic islands and bubbling mud pools, to breathtaking fjords and polar bears roaming the icy wilderness – the treasures of Iceland, Greenland and Spitsbergen are limitless.



Atlantic Walrus

**Sailing on**  
23rd May 2022

**Returns on**  
5th June 2022

**Duration**  
14 days

**Sailing from**  
● [Reykjavik, Iceland](#)

**Sailing to**  
● [Longyearbyen, Svalbard](#)

**Ship**  
[SH Vega](#)







#### MONACO GLACIER

Sail past Spitsbergen's most beautiful glacier as it calves icebergs into the Love Fjord.



#### NORDAUSTLANDET

Watch for polar bears in their denning area, roaming Svalbard reindeer or snorting Atlantic walrus hauling out.



#### LONGYEARBYEN

The world's most northerly town comes complete with the world's most northerly high street and pub.



Beautiful fjords, Svalbard

Join us in the land of fire and ice, exploring Iceland's vast fjords and unique geothermal landscape. As we sail on through the Greenland Sea, to Jan Mayen, a remote island snow-covered stratovolcano. Our journey continues on to the Arctic Circle's northern archipelago of Svalbard, where the sun dances across the icy landscape where numerous Arctic wildlife make their home.



White Svalbard Reindeer

Day	Visiting
1	Reykjavik, Iceland
2	Dynjandi, Iceland
3	Isafjordur / Vigur Island, Iceland
4	Akureyi, Iceland
5	At Sea
6	Jan Mayen Island, Norway
7	At Sea
8	Monaco Glacier, Svalbard
9	Nordaustlandet, Svalbard
10	Wijdefjorden, Svalbard
11,12	At Sea
13	Ny-Ålesund, Svalbard
14	Longyearben, Svalbard

Itineraries are correct at time of going to print and maybe subject to change.

# Svalbard Encompassed

Embark on this incredible 8-day Svalbard Circumnavigation cruise touring Norway's remote Svalbard archipelago within the Arctic Circle. Feast your eyes on the unique arctic environment as we voyage through this unforgettable icy wilderness.

**Sailing on**

5th June 2022 &  
12th June 2022\*

**Returns on**

12th June 2022 &  
19th June 2022

**Duration**

8 days

**Sailing from**

• Longyearbyen, Svalbard

**Sailing to**

• Longyearbyen, Svalbard

**Ship**

SH Vega

Colourful chalet houses in Longyearbyen





#### MONACO GLACIER

Sail past Spitsbergen's most beautiful glacier, Monacobreen, as it calves icebergs.

GREENLAND  
SEA



#### NY-ÅLESUND

Visit the spot where Roald Amundsen set off on his famed North Pole expedition in 1926.



#### LONGYEARBYEN

Keep an eye out for Reindeer roaming the lush tundra flats strewn with whalebones.

BARENTS  
SEA

Marvel at the alluring icy blue waters of the polar region as we sail past the glaciers and icebergs of this unique arctic environment. Learn more about this isolated polar region from our on board team of experts and enjoy endless days spotting the rarely seen wildlife that populates this region, including polar bears, walrus, beluga whales, reindeer and arctic foxes.



Polar Bear family,  
Svalbard



Iceberg, Nordaustlandet

Day	Visiting
1	Longyearbyen, Svalbard
2	Bellsund, Svalbard
3	Monaco Glacier, Svalbard
4,5	Nordaustlandet, Svalbard
6	Widdefjorden, Svalbard
7	Ny-Ålesund, Svalbard
8	Longyearbyen, Svalbard

\*The sailing on 12th June is an 8 day sailing, with slight variation in the length of time spent in each destination.

Itineraries are correct at time of going to print and maybe subject to change.

# Svalbard in Depth

LONGYEARBYEN TO TROMSO

Nestled within the Arctic Circle, Svalbard's landscape is uniquely enthralling. Cross the Arctic plains in search of walrus and polar bears, and sail through endless beautiful fjords under the midnight sun.

## Sailing on

19th June 2022

## Sailing from

• Longyearbyen, Svalbard

## Returns on

29th June 2022

## Sailing to

• Tromsø, Norway

## Duration

11 days

## Ship

SH Vega

Fresh morning light in Svalbard

Here, you'll encounter one of the most stunning landscapes on Earth. As you relax on board, you'll glide through tranquil waters where beluga whales swim, and glaciers calve huge icebergs into glistening fjords. The secrets of Norway's remote archipelagos truly reveal themselves once you step ashore. Wander through a unique tundra where wildflowers blossom and marvel at the rugged landscape, home to guillemots, little auks, walrus and polar bears.

Day	Visiting
1	Longyearbyen, Svalbard
2	Ny-Ålesund, Svalbard
3	Monaco Glacier, Svalbard
4,5	Nordautlandet, Svalbard
6	Wijdefjorden, Svalbard
7	Bellsund, Svalbard
8	Hornsund, Svalbard
9	Bear Island, Svalbard
10	At Sea
11	Tromsø, Norway

Itineraries are correct at time of going to print and maybe subject to change.



Tromsø, Norway



Ny-Ålesund, Svalbard



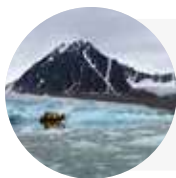

#### MONACO GLACIER

This vast wall of ice is known as Spitsbergen's most beautiful glacier.



#### WIJDEFJORDEN

Spitsbergen's longest fjord forms part of the stunning Inner Wijdefjord National Park.

GREENLAND SEA



#### NY-ÅLESUND

The starting point of Roald Amundsen's legendary North Pole expedition.



#### HORNSUND

Keep an eye out for polar bears, little auks and Svalbard reindeer.

NORWEGIAN SEA

• Bear Island

BARENTS SEA



#### BEAR ISLAND

The greatest bird cliff in the Barents Sea, home to thousands of breeding seabirds.



#### TROMSO

Known as the Arctic gateway, Tromsø is the perfect place to take in the soft glow of the midnight sun.

• Tromsø

NORWAY

# Svalbard in Depth

TROMSO TO LONGYEARBYEN

This in-depth cruise around Norway's remote Svalbard archipelago will leave you with unforgettable memories. Discover a land of dramatic, snow-peaked wonder.

**Sailing on**

29th June 2022

**Sailing from**

📍 Tromsø, Norway

**Returns on**

9th July 2022

**Sailing to**

📍 Longyearbyen, Svalbard

**Duration**

11 days

**Ship**

SH Vega



Arctic Fox in Autumn

Welcome to Svalbard: the domain of the polar bear. Rugged, remote island landscapes reveal a unique Arctic environment. As we cruise the world's northernmost settlements, take in the unmissable vast glaciers under the midnight sun, peer into deep and beautiful fjords and follow in the footsteps of legendary explorers.

Day	Visiting
1	Tromsø, Norway
2	At Sea
3	Bear Island, Svalbard
4	Hornsund, Svalbard
5	Bellsund, Svalbard
6	Wijdefjorden, Svalbard
7,8	Nordaustlandet, Svalbard
9	Monaco Glacier, Svalbard
10	Ny-Ålesund, Svalbard
11	Longyearbyen, Svalbard

Itineraries are correct at time of going to print and maybe subject to change.

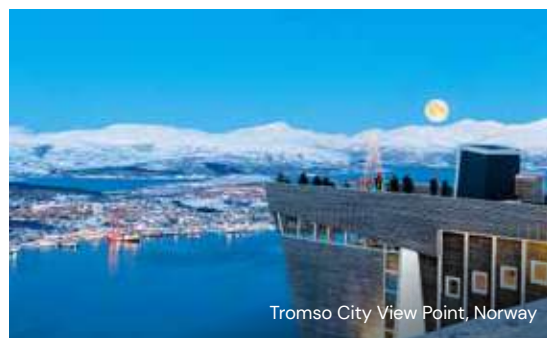

Tromsø City View Point, Norway



Little Auks





#### MONACO GLACIER

Excursions include walking above this beautiful glacier, watching icebergs calve into Liefdefjorden.



#### NORDAUSTLANDET

Part of the Nordaust-Svalbard Nature Reserve, glittering Nordaustlandet is mostly covered in ice caps.

GREENLAND SEA

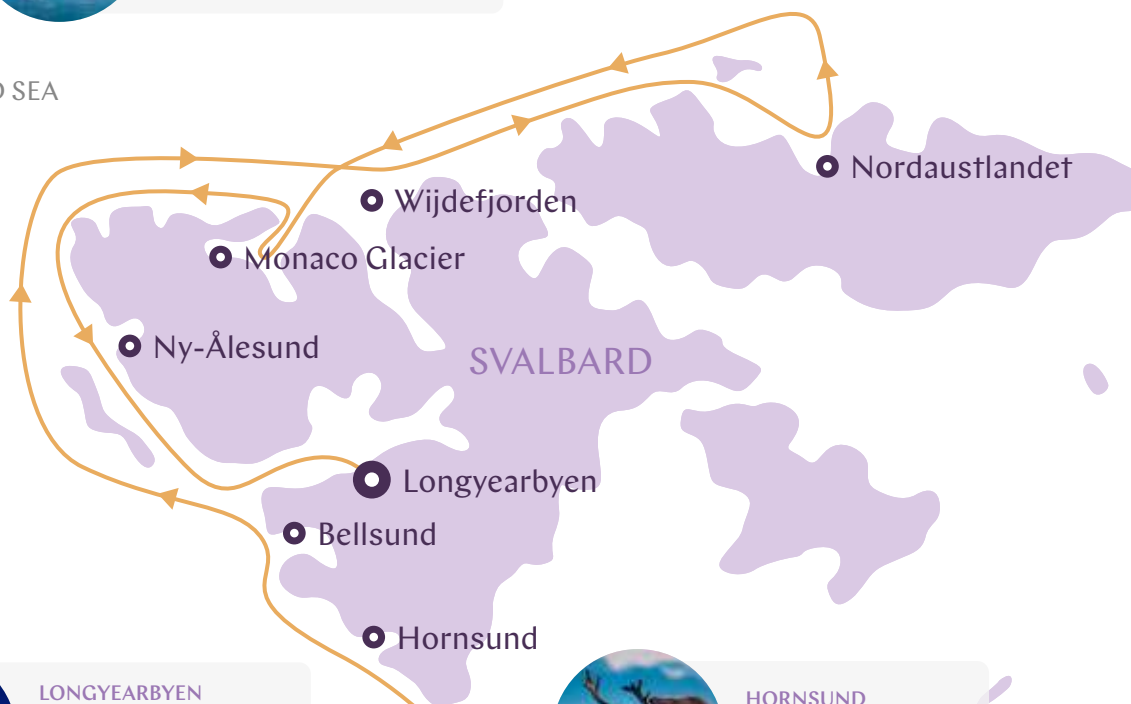

#### LONGYEARBYEN

The world's most northerly town comes complete with the world's most northerly high street and pub.



#### HORNSUND

Keep an eye out for polar bears, little auks and Svalbard reindeer.

NORWEGIAN SEA

BARENTS SEA

• Bear Island



#### BEAR ISLAND

Sail alongside steep cliffs, where distinctive sea stack rock columns have been carved by time.



#### TROMSØ

This remote Norwegian city is famed for the Northern Lights on winter nights.

• Tromsø

NORWAY

# Arctic Discovery

SVALBARD, FRANZ JOSEF LAND & NOVALIA ZEMLYA

Awaken your inner explorer on this life-changing extended expedition across the Arctic. Cruise past majestic fjords and through ice-choked waters which reveal rarely seen wildlife, before closing your journey on Siberia's mighty Yenisei river – one of the world's last undiscovered wildernesses.

**Sailing on**  
9th July 2022

**Returns on**  
28th July 2022

**Duration**  
20 days

**Sailing from**  
Longyearbyen, Svalbard

**Sailing to**  
Dudinka, Russia

**Ship**  
SH Vega



## SVALBARD

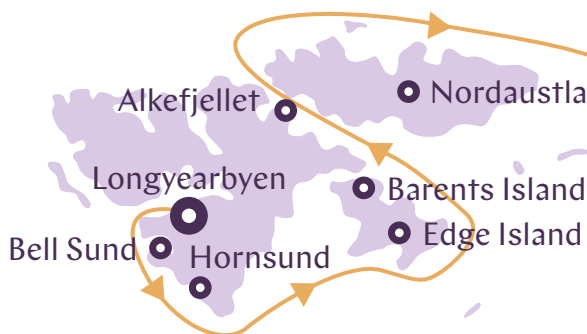

### HORNSUND

Considered by some as the most beautiful in Spitsbergen, this stunning fjord is surrounded by spectacular glaciers where polar bears roam.



### EDGE ISLAND

The rich tundra of this nature reserve supports once-near-extinct Svalbard reindeer, and herds of walrus haul out on the shore.

## BARENTS SEA



### SEVERNY ISLAND

Part of an archipelago that (until recently) was closed off to visitors, the island's ice cliffs are a must-see, with its nesting birds and calving icebergs.

SWEDEN

DISCOVER MORE AT [SWANHELLENIC.COM](http://SWANHELLENIC.COM)





Polar Bear on the edge of an ice floe



MacKlintok Island



Dudinka, Russia

LAND



#### ALEXANDRA LAND

Only accessible by icebreaker, 1,000 km from the North Pole, Alexandra Land is the gateway to the Russian High Arctic.



Sail across the top of the world, through remote Russian and Norwegian archipelagos and Siberia's untouched wilderness. Immerse yourself in the wild majesty of nature as belugas, bowheads, narwhals, polar bears, walruses, and millions of seabirds journey alongside. On the Yenisei river, experience a rare opportunity to go back in time to a bygone industrial era, and to meet and learn about the history and traditions of the Nenets indigenous people.

Day	Visiting
1	Longyearbyen, Svalbard
2	Bell Sund, Svalbard
3	Hornsund, Svalbard
4	Edge Island, Svalbard
5	Barents Island, Svalbard
6	Alkefjellet, Svalbard
7	Nordautlandet, Svalbard
8	Kvitoya, Svalbard
9	Alexandra Land, Russia
10,11	Zemlya Georga, Russia
12	Hooker Island, Russia
13	MacKlintok Island, Russia
14,15	Severny Island, Novaya Zemlya
16,17	At Sea
18	Yenisei River, Russia
19,20	Dudinka, Russia

Itineraries are correct at time of going to print and maybe subject to change.

# Arctic in Depth

## SIBERIA TO NORWAY

Discover history and tradition as they combine along Siberia's mighty Yenisei River. Learn about the culture and traditions of the locals, then venture on to remote islands and far-flung archipelagos where nature is vast and wild.

**Sailing on**  
28th July 2022

**Returns on**  
12th August 2022

**Duration**  
16 days

**Sailing from**  
Dudinka, Russia

**Sailing to**  
Tromsø, Norway

**Ship**  
SH Vega



### ALKEFJELLET

The towering cliffs of Alkefjellet teem with 60,000 breeding pairs of Brünnich's guillemots – our Zodiacs will get up close to this incredible sight.

### BARENTS SEA



### DUDINKA

Immerse yourself in indigenous peoples' culture at Taimyr-mou, then tour the stunning nature of Putorana plateau, a UNESCO World Heritage Site.





Alkefjellet cliffs



Bearded Seal, Alkefjellet



Alexandra Land

LAND

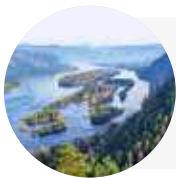

#### YENISEI RIVER

As we pass through the Taymyr Peninsula, we get to meet the Nenets, an indigenous people from northern arctic Russia.



Heading north, you'll first be welcomed by the Nenets people as you cruise past abandoned Russian towns bordering the Kara Sea, and magnificent icy landscapes in the Russian High Arctic. As you approach the far-flung Norwegian archipelago of Svalbard, listen for the sound of icebergs calving from vast glaciers, and watch for extraordinary Arctic wildlife including millions of seabirds on the greatest bird cliff in the Barents Sea.

Day	Visiting
1,2	Dudinka, Russia
3	Yenisei River, Russia
4	At Sea
5,6	Severny Island, Novaya Zemlya
7	Hooker Island, Franz Josef Land
8	Zemlya Georg, Franz Josef Land
9	Alexandra Land, Franz Josef Land
10	Kvitoya, Svalbard
11	Nordautlandet, Svalbard
12	Alkefjellet, Svalbard
13	Barents Island, Svalbard
14	Hornsund, Svalbard
15	At Sea
16	Tromso, Norway

Itineraries are correct at time of going to print and maybe subject to change.

# Arctic Explorer

FRANZ JOSEF LAND, SPITZBERGEN & ICELAND

Get away from it all on our 19-day Arctic Explorer cruise from Norway to Iceland via the remote Russian archipelago of Franz Josef Land in the Russian High Arctic where pioneers and scientists stepped ashore.

**Sailing on**  
12th August 2022

**Returns on**  
30th August 2022

**Duration**  
19 days

**Sailing from**  
• Tromsø, Norway

**Sailing to**  
• Reykjavik, Iceland

**Ship**  
SH Vega

Hot Springs, Iceland

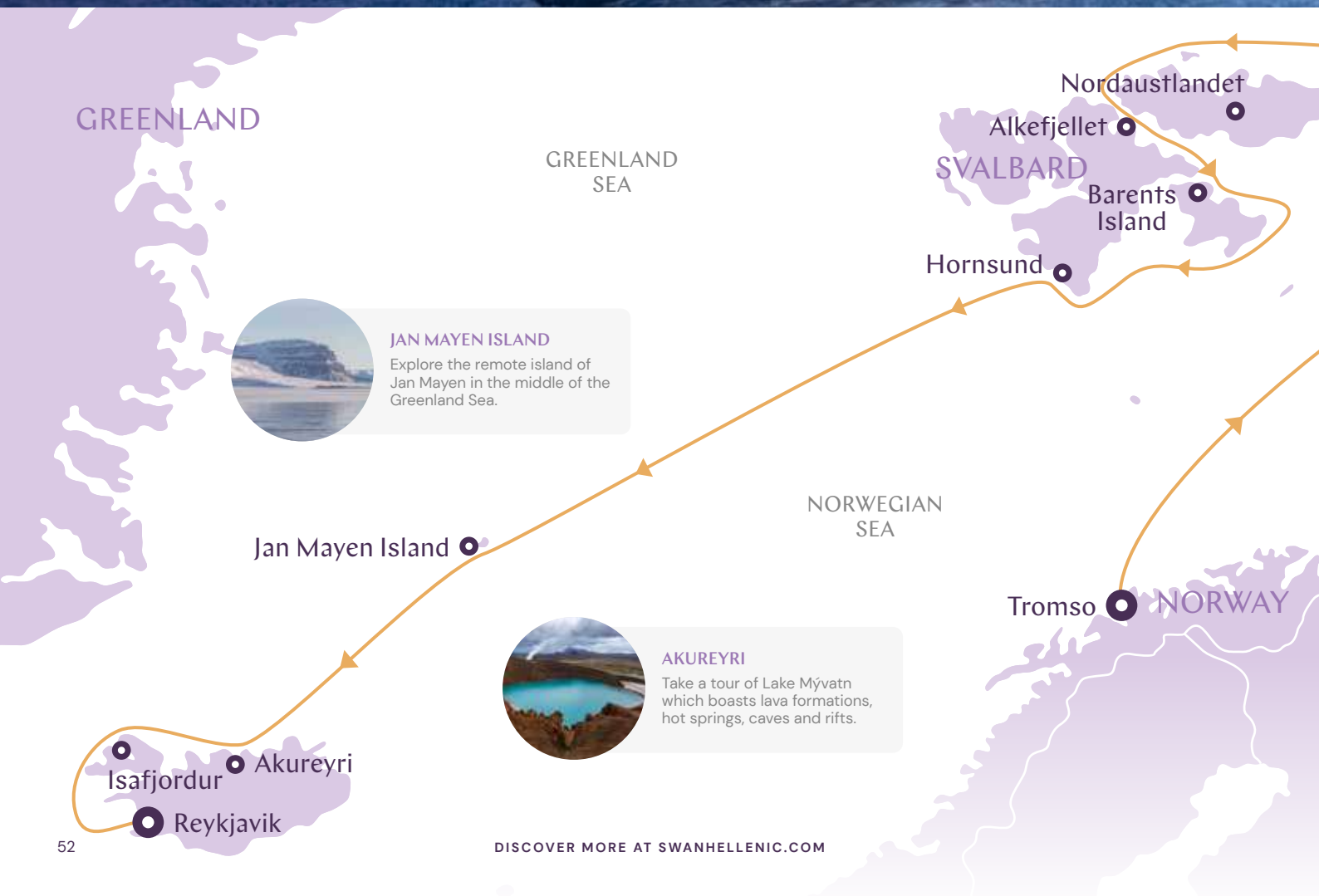





Guillemot birds, Alkefjellet



Tromsø, Norway

This remarkable journey takes you past Spitsbergen's towering glaciers calving spectacular icebergs across the Greenland Sea to Iceland, the land of fire and ice. Watch polar bears carrying their cubs and fluking whales in the icy waters. Join us on our voyage of discovery as we sail from ice-bound islands to hot springs, spouting geysers and gushing waterfalls.

Day	Visiting
1	Tromsø, Norway
2,3	At Sea
4	Alexandra Land, Franz Josef Land
5,6	Zemlya Georga, Franz Josef Land
7	MacKlintok Island, Franz Josef Land
8	Hooker Island, Franz Josef Land
9	Kvitøya (White Island)
10	Nordauslandet, Svalbard
11	Alkefjellet, Svalbard
12	Barents Island, Svalbard
13	Hornsund, Svalbard
14	At Sea
15	Jan Mayen Island
16	At Sea
17	Akureyri, Iceland
18	Isafjordur / Vigur Island, Iceland
19	Reykjavik, Iceland

Itineraries are correct at time of going to print and maybe subject to change.

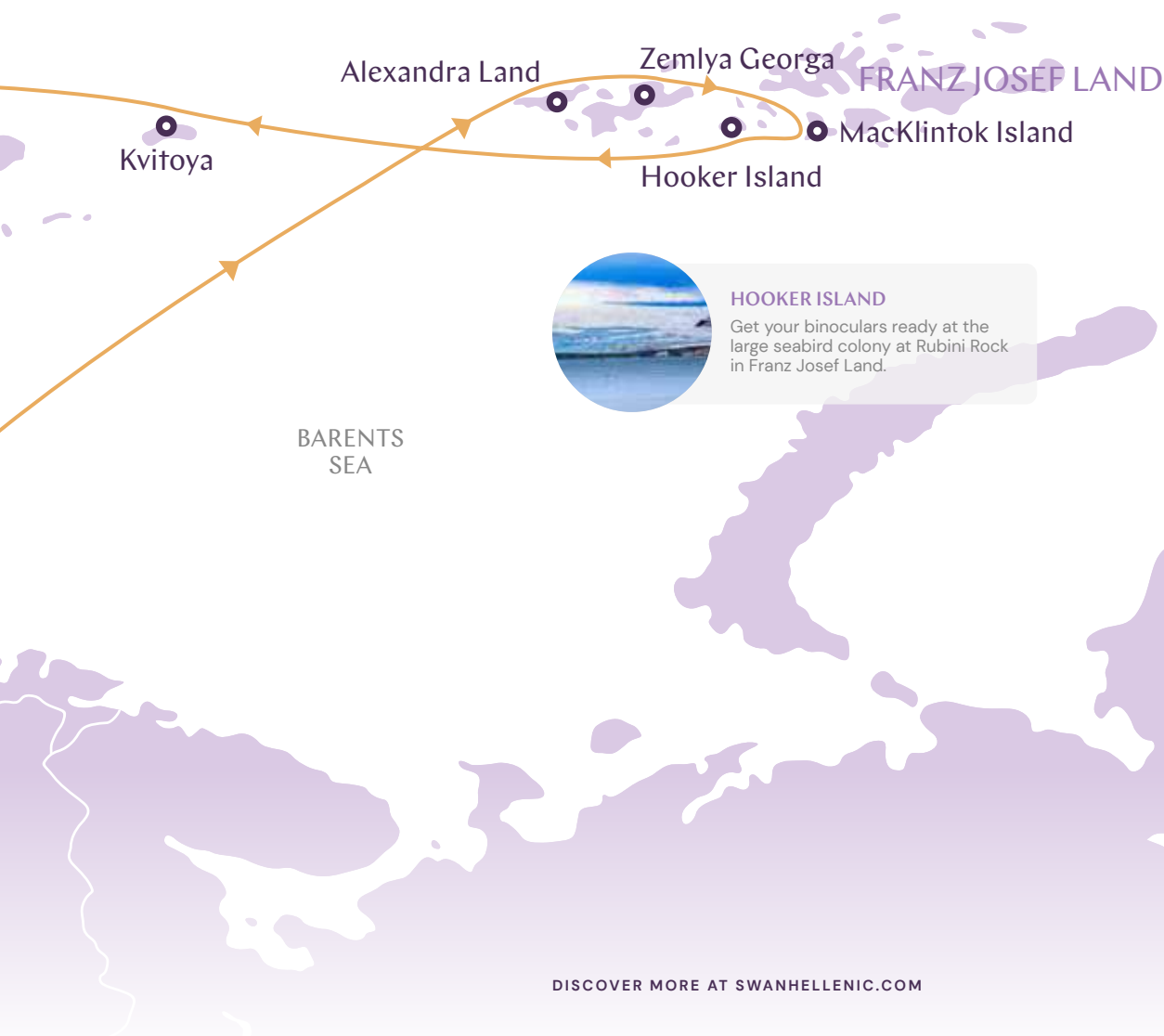

# Greenland Discovery

## REYKJAVIK TO GREENLAND

Experience a remote and remarkable region, where traditional ways of life thrive against a backdrop of stunning arctic scenery and immense mountains. Learn about the dramatic history of the Norse people on our tour of a fascinating and varied part of Greenland.

**Sailing on**  
30th August 2022

**Returns on**  
9th September 2022

**Duration**  
11 days

**Sailing from**  
Reykjavik, Iceland

**Sailing to**  
Kangerlussuaq, Greenland

**Ship**  
SH Vega







Sunset in Nuuk, Greenland



Prins Christian Sound



Arctic walrus



#### REYKJAVIK

Explore cosy bars, cafes and shops on streets heated by geothermal waters.

NORTH ATLANTIC  
OCEAN

Take in views of river valleys and hillsides that shelter Norse settlements dating back more than 4,500 years – their secrets buried deep within. Discover UNESCO World Heritage Sites, Viking ruins, and the paths of Inuit migrations alongside unspoilt, picturesque waterways lined with crystal-clear waterfalls.

Day	Visiting
1	Reykjavik, Iceland
2	At Sea
3	Skjoldungen, Greenland
4	Prins Christian Sound & Aappilattoq, Greenland
5	Ivigut, Greenland
6	Nuuk (Godthab), Greenland
7	Sisimiut, Greenland
8	Ilulissat, Greenland
9	Disko Bay, Greenland (Cruising)
10, 11	Kangerlussuaq, Greenland

Itineraries are correct at time of going to print and maybe subject to change.

# Canadian Arctic Discovery

## GREENLAND & CANADIAN ARCTIC

Home to some of the most active glaciers in the world, this sailing uncovers where polar bears roam. Visit UNESCO World Heritage Sites, Inuit communities and Viking ruins in a history lesson like no other. In these Arctic waters, time seems to stand still.

**Sailing on**  
9th September 2022

**Sailing from**  
• Kangerlussuaq, Greenland

**Returns on**  
25th September 2022

**Sailing to**  
• Kangerlussuaq, Greenland

**Duration**  
17 days

**Ship**  
SH Vega

This unforgettable cruise reveals the most breathtaking destinations of the High Arctic. Among mountainous icebergs, spot polar bears and glimpse narwhal breaking the Arctic waters. Follow in the footsteps of some of history's greatest explorers as we navigate from colourful harbour houses and charming fjords to beguiling flower-laden landscapes. This trip is a unique chance to dip into tumultuous Viking history, and learn about native culture from our onboard experts.

Day	Visiting
1	Kangerlussuaq, Greenland
2	Sisimiut, Greenland
3	Uumannaq, Greenland
4	At Sea
5	Buchan Gulf, Nunavut
6	Pond Inlet, Nunavut
7	Sirmilik National Park, Bylot Island
8	Peel Sound (Cruising)
9	Beechey Island, Nunavut
10	Dundas Harbour, Devon Island, Nunavut
11	Ellesmere Island, Nunavut
12	At Sea
13	Upernavik, Greenland
14	Qeqertarsuaq, Greenland
15	Ilulissat, Greenland
16	At Sea
17	Kangerlussuaq, Greenland

Itineraries are correct at time of going to print and maybe subject to change.



### BEECHEY ISLAND

Important historic sites include the spot where Sir John Franklin wintered during his fateful 1845-46 Expedition.

Beechey Island, Nunavut

Cruise Peel Sound

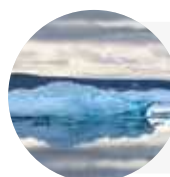

### PEEL SOUND

This pack ice-filled channel was notorious to 19th-century explorers. Look out for polar bears as you pass through.

CANADA





Buchan Gulf, Canada





# Northern Canada Discovery

## GREENLAND TO NOVA SCOTIA

Trace a path along the legendary ice-filled route that challenged many a great explorer in years gone by. Combining adventure and culture, this epic voyage along the Northwest Passage is something every traveller should experience in their lifetime.

**Sailing on**  
25th September 2022

**Returns on**  
10th October 2022

**Duration**  
16 days

**Sailing from**  
Kangerlussuaq, Greenland

**Sailing to**  
Halifax, Canada

**Ship**  
SH Vega

Waterfall in Qeqertarsuaq

As we sail from Greenland through the iceberg capital of the world, gaze in awe at the ice-filled straits and fjords that glisten as you drift by. The northern Canadian coast around Nunavut is a haven for caribou and polar bears, and in Newfoundland you'll hear the stories of the indigenous Inuit people and discover ancient whaling sites. On board, learn about the history of Viking exploration from our team of passionate experts.

Day	Visiting
1	Kangerlussuaq, Greenland
2	At Sea
3	Qeqertarsuaq (Disko Bay), Greenland
4	Ilulissat, Greenland
5	Sisimiut, Greenland
6	Nuuk (Godthab), Greenland
7	At Sea
8	Iqaluit, Nunavut
9	Lady Franklin Island, Canada
10	Akpatok Island, Nunavut
11	Torngat Mountains National Park, Canada
12	At Sea
13	Belle Isle Straits, Canada (Cruising)
14	Corner Brook, Canada
15	At Sea
16	Halifax, Canada

Itineraries are correct at time of going to print and maybe subject to change.



Halifax, Canada



Orca Pod





#### QEQERTARSUAQ

Part of Disko Bay, a UNESCO World Heritage Site. The Lyngmark Glacier rises above the town, where basalt columns and black sand beaches reflect its volcanic origin.

Qeqertarsuaq (Disko Bay)

Ilulissat

LABRADOR SEA

GREENLAND

Sisimiut

Kangerlussuaq

Nuuk (Godthab)



#### IQALUIT

In this remote community, gain insight into Inuit history and culture including dog-sledding on handmade qamutik sleds led by qimmiiq – North America's oldest and rarest purebred canine.

Iqaluit, Nunavut

Lady Franklin Island

Akpatok Island, Nunavut

Torngat Mountains National Park

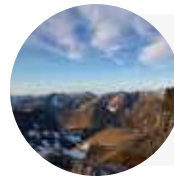

#### TORNGAT MOUNTAINS NATIONAL PARK

A rare chance to follow in the footsteps of Inuit as they share their stories of spirits and traditions in their homeland, with a backdrop of dramatically spectacular mountains and deep fjords.

CANADA



#### LADY FRANKLIN ISLAND

The island's huge vertical cliffs of Archean rocks are reputedly the oldest stones in Canada. Monumental Island to the south is a prime spot for walrus and polar bear spotting.

Belle Isle Straits

Corner Brook

Halifax



#### CORNER BROOK

This is the gateway to adventure tours – ziplining, fishing, spelunking – in scenic Humber Valley or further north among the sheer cliffs and waterfalls of Gros Morne National Park.



# Russian Far East. Or the world's biggest hidden gem?

**Size**  
6.2 million square km

**Largest cities**  
Vladivostok, Khabarovsk,  
Ulan-Ude

**When we sail**  
May–August

Remote and mysterious, the Russian Far East is steeped in history and culture. Once seemingly inaccessible thanks to travel-restricted areas, now more and more travellers are able to appreciate its unparalleled beauty. This great, pristine wilderness is largely uninhabited, yet its snow-tipped peaks, smoking volcanoes, lush tundra and abundant wildlife make it a joy to discover.





Fresh morning sunshine



# Kamchatka & Aleutian Islands Discovery

## SEWARD TO OTARU

Our unforgettable adventure starts in Seward, Alaska, a stunning landscape carved out by glaciers. Journey through icy fjords, teeming with wildlife, before crossing the Pacific Ring of Fire and onward to Otaru, Japan.

**Sailing on**  
17th May 2022

**Returns on**  
5th June 2022

**Duration**  
19 days

**Sailing from**  
• Seward, Alaska

**Sailing to**  
• Otaru, Japan

**Ship**  
SH Minerva



### OLD HARBOR, KODIAK ISLAND

This picturesque island provides the perfect base for kayaking and salmon fishing, as well as wildlife spotting, with whales, sea-lions and seals in abundance.

### YANKICHA ISLAND

A wildlife spotter's paradise, this rocky island is home to sea otters, rare Whiskered Auklets, Arctic Foxes and songbirds.





Whale diving, Alaska



Volcanic sunset over  
Petropavlovsk Kamchatskiy



Kodiak Brown Bear



#### CHISWELL ISLANDS

These rocky, uninhabited islands are home to various bird species who nest there, including horned puffins and black-legged kittiwakes.

Sail from Seward through the coastal fjords, as we travel through the remote villages and harbours that dot the Alaskan coastline. Traverse volcanic islands, adventure through Russia's Far East and uncover the quaint preserved canals of Otaru, Japan. Discover the rich history of the area with our knowledgeable team of onboard experts.

Day	Visiting
1	Seward
2	Holgate Glacier & Chiswell Islands (Cruise)
3	Kodiak
4	Semidi Islands
5	The Haystacks & Unga Island
6	Dutch Harbor
7	Seguam Island
8	At Sea
9	Kiska Harbour
10	Attu Island
11,12	At Sea
13	Petropavlovsk (Kamchatsky)
14	Atlasov Island, Kuril Islands
15	Yankicha Island
16	Urup, Kuril Islands
17	At Sea
18	Korsakov
19	Otaru, Japan

Itineraries are correct at time of going to print and maybe subject to change.



# Russia's Ring of Fire

## SEA OF OKHOTSK WILDLIFE & VOLCANOES

A nature-lover's dream, this cruise takes you through some of the most stunningly beautiful horizons – from remote islands with incredible wildlife spotting and hot springs to the striking volcanic landscapes of Russia's Far East.

**Sailing on**  
5th June 2022

**Returns on**  
15th June 2022

**Duration**  
11 days

**Sailing from**  
● Otaru, Japan

**Sailing to**  
● Otaru, Japan

**Ship**  
SH Minerva



Grey Seal sleeping on the rocks





Atlasov Island, Russia

Immerse yourself in the lush landscapes of the seldom-visited islands in Russia's Far East. Here, in warm waters heated by geothermal activity, spot fur seals and sea lions with their pups. Sail past historic landmarks to active fumaroles and hot lagoons as you learn about volcanology from our expert guides and count yourself one of the lucky few who are able to visit these otherworldly, far-flung places.



Tomioka Cathedral in Otaru, Japan

Day	Visiting
1	Otaru
2	Korsakov
3	Tyuleniy Island
4	At Sea
5	Yankicha Island
6	Atlasov Island
7	Sarychev Peak, Matua Island
8	Natalii Bay, Urup Island
9	At Sea
10	Korsakov
11	Otaru

Itineraries are correct at time of going to print and maybe subject to change.

# Kamchatka & Aleutian Islands Discovery

## OTARU TO SEWARD

Otaru in Japan makes the perfect starting point for this once-in-a-lifetime adventure through Russia's Far East and the glaciated wonders of Alaska. Escape into vast, volcanic landscapes as you cross the Pacific Ring of Fire.

**Sailing on**  
15th June 2022

**Returns on**  
3rd July 2022

**Duration**  
20 days

**Sailing from**  
Otaru, Japan

**Sailing to**  
Seward, Alaska

**Ship**  
SH Minerva



### ATTU ISLAND

The location of the only World War II land battle fought in the United States, now a birders' paradise and the setting for comedy film The Big Year.

BERING SEA

RUSSIA

SEA OF OKHOTSK

Petropavlovsk-Kamchatskiy

Atlasov Island

Attu Island

Kiska Harbor

Seguam Island

Korsakov

Yankicha Island

Urup

JAPAN

Otaru

NORTH PACIFIC OCEAN

### DUTCH HARBOR

Alongside around 9,000 years of native Aleut history, spot strong Russian Orthodox influences in characteristic onion dome architecture.





Set sail north from Otaru to the isolated reaches of the northern Pacific. As you hike among the chains of oceanic islands, you'll discover the unique flora and fauna that thrive in these volcanic lands, and delve deep into sites of historical significance alongside our team of experts.

Day	Visiting
1	Otaru, Japan
2	Korsakov, Russia
3	At Sea
4	Urup, Kuril Islands
5	Sarychev Peak, Kuril Islands
6	Atlasov Island, Kuril Islands
7	Petropavlovsk-Kamchatskiy, Kamchatka
8,9	At Sea
10	Attu Island
11	Kiska Harbour
12	At Sea
13	Seguam Island
14	Dutch Harbor
15	Unga Island & The Haystacks
16	Chignik
17	Old Harbour, Kodiak Island
18	Chiswell Islands
19	Holgate Glacier (Cruise)
20	Seward

Itineraries are correct at time of going to print and maybe subject to change.



# Aleutian Islands, Russian Far East & Bering Sea Discovery

## SEWARD TO NOME

Sailing from Alaska to Russia, circumnavigating the Bering Sea. The few who experience this incredible journey – with its epic volcanic landscapes and remarkable wildlife – will undoubtedly remember it forever.

**Sailing on**  
3rd July 2022

**Returns on**  
19th July 2022

**Duration**  
17 days

**Sailing from**  
● Seward, Alaska

**Sailing to**  
● Nome, Alaska

**Ship**  
SH Minerva

Chiswell Islands, Alaska





This unique voyage takes in the northern part of the Pacific Ring of Fire, from Alaska and the Aleutian Islands to Kamchatka and the Kuril islands in Russia's Far East. As we circumnavigate the Bering Sea, magnificent volcanos and jagged cliffs brimming with birds are just a few of the highlights: these are some of the least-visited places on the planet, where brown bears, sea lions, whales and puffins make thrilling company.

Day	Visiting
1	Seward, Alaska
2	Holgate Glacier & Chiswell Islands, Alaska
3	Larsen Bay, Alaska
4	Castle Bay, Alaska
5	Unga Island, Alaska
6	Dutch Harbor, Alaska
7	St Paul Island, Alaska
8	St Matthew Island, Alaska
9	Provideniya, Russia
10	Naukan & Uelen Village, Russia
11	Kolyuchin Island, Russia
12	Lavrentiya, Russia
13	Proliv Senyavina Hot Springs & Yttygran Island, Russia
14	Nunligan, Russia
15	Sireniki, Russia
16	Provideniya, Russia
17	Nome, Alaska

Itineraries are correct at time of going to print and maybe subject to change.



# Far East Arctic Highlights

## EASTERN RUSSIA & WRANGEL ISLAND

Where mammoth and sabre-toothed tigers once roamed, these remote northern islands unveil their pristine natural environments alongside a warm welcome from the indigenous Siberian Yupik who call this distant region home. This sailing visits Wrangel Island, probably the most populous polar bear habitat on earth.

**Sailing on**

19th July 2022

**Returns on**

2nd August 2022

**Duration**

15 days

**Sailing from**

• Nome, Alaska

**Sailing to**

• Nome, Alaska

**Ship**

SH Minerva



Polar Bear sitting on an ice floe





#### MEDVEZHIY ISLANDS

Polar bears famously frequent this isolated archipelago. The natural rock pillars on Chetyrbok Stolbovoy are a sight to behold.



#### KRASIN BAY & CAPE WARING

See the relics of a 3,400-year-old Paleo-Eskimo camp, a huge number of polar bear dens and beaches strewn with long-extinct dwarf mammoth tusks.

Medvezhiy Islands

Ushakova Cape

WRANGEL ISLAND

Cape Florens

Cape Waring

Krasin Bay

Ayon Island



#### AYON ISLAND

Visit a quaint museum set up by local children, then venture to the outskirts of Ayon Village to explore a Neolithic settlement.

Kolyuchin Island

Cape Dezhnev

Proliv Senyavina

Provideniya

Yttygran Island

Nome

RUSSIA

ALASKA



#### PROVIDENIYA

Learn more about Yupik culture on a visit to a settlement at Novoye Chaplino overlooking a picturesque fjord.



#### YTTYGRAN ISLAND

Stretch your legs and ponder the origins of Whale Bone Alley, an eerie archaeological site lined with whale bones, some five metres high.

INTERNATIONAL DATE LINE

A cruise to this isolated Arctic region is a unique adventure. Landing on Wrangel Island feels like stepping into prehistoric Earth. Across Eastern Russia, the hammocky tundra is home to unique flora and fauna, and is one of the best places on earth to see polar bears, Pacific walrus, puffins and snow geese. In these far-flung abundant areas, you'll meet the indigenous Siberian Yupik and learn about their culture.



Wrangel Island



Yttygran Island

Day	Visiting
1	Nome, Alaska
2	Provideniya, Russia
3	Cape Dezhnev/Uelen Village, Russia
4	Kolyuchin Island, Russia
5	At Sea
6	Ayon Island, Russia
7	Medvezhiy Islands, Russia
8	At Sea
9	Ushakova Cape, Wrangel Island
10	Cape Florens, Wrangel Island
11	Krasin Bay & Cape Waring, Wrangel Island
12	At Sea
13	Proliv Senyavina Hot Springs & Yttygran Island, Russia
14	Provideniya, Russia
15	Nome, Alaska

Itineraries are correct at time of going to print and maybe subject to change.

# Far East Arctic in Depth

## EASTERN RUSSIA & WRANGEL ISLAND

This far north, time really does seem to stand still. Cruise along the edge of pack ice, spotting polar bears and seals along vast, otherworldly landscapes. This is life at the top of the world.

**Sailing on**  
2nd August 2022

**Returns on**  
20th August 2022

**Duration**  
19 days

**Sailing from**  
Nome, Alaska

**Sailing to**  
Nome, Alaska

**Ship**  
SH Minerva

### Ice Edge Cruising

### De Long Islands



#### EXPEDITION DE LONG ISLANDS

Five islands make up this uninhabited archipelago: find preserved mammoth remains on Zhokhov Island, while Bennett Island boasts a stunning glaciated, volcanic landscape.

### EAST SIBERIAN SEA

### Lyakhovsky Island

### Dmitry Laptev Strait

### Medvezhyi Islands

### Ayon Island

### Ushakova Cape

### Cape Florens

### Cape Blossom

### Krasin Bay

### Kolyuchin Island Kolyuchin Bay

### WRANGEL ISLAND

### RUSSIA



#### ICE EDGE CRUISING

Head out on deck as our polar class ship breaks through the pack ice, and watch for polar bears, walrus and seals among the ice floes in the distance.



#### AYON ISLAND

Here, the indigenous Chukchi population are reindeer herders. Many live in Ayon Village, a coastal settlement where we are guaranteed a warm welcome.





Provideniya, Russia



Kolyuchin Island



Spoon-billed Sandpiper



#### CAPE FLORENS & CAPE BLOSSOM

Named for the colourful flora and wildflowers on the mossy tundra, Cape Florens helped give Wrangel Island its unique status as the northernmost UNESCO World Heritage Site.

INTERNATIONAL  
DATE LINE



#### NOME

Excursions include mushing, panning for gold on the beaches and trips to the Bering Land Bridge National Preserve.

Cape Waring

Uelen Village  
Cape Dezhnev

ALASKA

Nome

Provideniya

As you drift past far-flung Russian islands, you'll witness nature flourishing in these harsh surroundings. Frozen seas and tundra provide a backdrop where hundreds of polar bears, walrus, puffins, snow geese and rare spoon-billed sandpipers make their home. Plus, experience the warm welcome of the Siberian Yupik as you share their rich culture.

Day	Visiting
1	Nome, Alaska
2	Provideniya, Russia
3	Cape Dezhnev & Uelen Village, Russia
4	Kolyuchin Bay & Kolyuchin Island, Russia
5	At Sea
6	Ayon Island, Russia
7	Medvezhiy Islands, Russia
8	At Sea
9	Dmitry Laptev Strait & Lyakhovsky Island, Russia
10	At Sea
11	Ice Edge (Cruising)
12	Expedition De Long Islands, Russia
13	At Sea
14	Ushakova Cape, Wrangel Island
15	Cape Florens & Cape Blossom, Wrangel Island
16	Krasin Bay & Cape Waring, Wrangel Island
17	At Sea
18	Provideniya, Russia
19	Nome, Alaska

Itineraries are correct at time of going to print and maybe subject to change.

DISCOVER MORE AT [SWANHELLENIC.COM](http://SWANHELLENIC.COM)

# Journey Across the Bering Sea

ALEUTIAN ISLANDS, KAMCHATKA KURIL ISLANDS & SAKHALIN ISLAND

Escape on an epic voyage to isolated and vast uninhabited regions of the northern Pacific. Featuring endless volcanic landscapes, tundra filled with wildflowers, and the rarest wildlife, these islands are a nature-lover's dream.

**Sailing on**  
20th August 2022

**Returns on**  
10th September 2022

**Duration**  
21 days

**Sailing from**  
• Nome, Alaska

**Sailing to**  
• Otaru, Japan

**Ship**  
SH Minerva



## PETROPAVLOVSK

Near this beautifully rustic city, Avacha Bay is an unforgettable treat: see the iconic Three Brothers sea stacks where Steller sea lions bask.



## TYULENIY ISLAND

See Steller sea lions cohabiting with more than 100,000 northern fur seals, who gather here on the beaches. Look out for black fur pups being nursed in these dense rookeries.

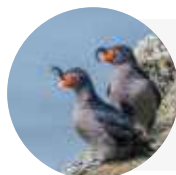

## KISKA HARBOR

Relics of Japanese occupation remain here, including a Shinto shrine as well as old naval artifacts scattered across the land.





Yankicha Island



Otaru, Japan



Kittiwakes colony at St. George Island



#### ST GEORGE ISLAND

In the 'Galapagos of the North', you can encounter more than 200 species of birds. A new species of beaked whale was discovered near the island in 2016.

Itineraries are correct at time of going to print and maybe subject to change.

As you navigate the oceanic islands of the northern Pacific Ring of Fire, discover rarities like St George Island – 'the Galapagos of the North'. From prolific birdlife in the Pribilof Islands to the abundant wildlife of the tundra regions, in these remote lands you'll see sights found nowhere else on Earth. On shores where only a few intrepid travellers and indigenous peoples have set foot, with the help of our expedition team, you'll see the world from a true explorer's perspective.

Day	Visiting
1	Nome, Alaska
2	Nunam Iqua, Alaska
3	Kangirivar Island, Alaska
4	Cape Newenham, Alaska
5	St Paul Island, Alaska
6	St George Island, Alaska
7	Amak Island, Alaska
8	Akutan Island, Alaska
9	Dutch Harbor, Alaska
10	At Sea
11	Kiska Harbor, Alaska
12	Attu Island, Alaska
13	At Sea
14	Petropavlovsk (Kamchatsky), Kamchatka
15	Russkaya Bay & Utashud Island, Kamchatka
16	Atlasov Island, Kuril Islands
17	Yankicha Island & Ketoy Island, Kuril Islands
18	Chirpoy Island, Kuril Islands
19	Tyuleni Island, Sea of Okhotsk
20	Korsakov, Sakhalin Island
21	Otaru, Japan

# A vast ocean. Or a wave of inspiration?

## Key destinations

Japan, Papua New Guinea,  
Argentina, Tahiti, Guatemala,  
Peru, USA and the UK

## When we sail

February – May  
September – November

Imagine tracing a languid route through some of the most beautiful destinations on the planet, gaining a new, wonderful perspective as you explore every port of call. From iconic cities in regions such as Europe, the Far East and South America to far-flung island idylls in the South Pacific and Caribbean, our stylish ships will transport you all around the world.





# In the wake of Darwin's HMS Beagle

## CHILEAN FJORDS DISCOVERY

Explore dramatic fjords, towering glaciers and fascinating history in comfort and style as you traverse the bottom of the world on our 14-day Chilean Fjords cruise.

**Sailing on**

20th February 2022

**Returns on**

5th March 2022

**Duration**

14 days

**Sailing from**

• [Ushuaia, Argentina](#)

**Sailing to**

• [Valparaíso, Chile](#)

**Ship**

[SH Minerva](#)

Garibaldi Glacier





Your journey starts in Ushuaia, said to be the world's most southerly city, before continuing on an intrepid exploration of some of the biggest, best-known and most interesting fjords and glaciers in the southern hemisphere. Spot the famed Andean condor, visit the renowned granite pillars of Torres del Paine National Park, and stop in at charming coastal settlements along the way.

Day	Visiting
1	Ushuaia
2	Garibaldi Glacier
3	Fjords (Cruise)
4,5	Puerto Natales
6	Fjords (Cruise)
7	Pio XI Glacier
8	Tortel
9	At Sea
10	Castro
11	Puerto Montt
12	At Sea
13	Isla Mocha
14	Valparaíso

Itineraries are correct at time of going to print and maybe subject to change.



# Deserts of the Pacific Coastline

## CHILE TO PERU

Explore beyond world class coastal towns and bustling cosmopolitan cities. Discover uninhabited wildlife havens, arid deserts and cultural hotspots on this 11-day cruise along the Chilean and Peruvian coastline.

**Sailing on**

5th March 2022

**Returns on**

15th March 2022

**Duration**

11 days

**Sailing from**

● Valparaíso, Chile

**Sailing to**

● Callao (Lima), Peru

**Ship**

SH Minerva

Nazca Line drawings, Pisco Bay





#### PISCO

Take a scenic flight over the vast, ancient and mysterious Nazca Line drawings



#### PISCO

Visit the undisturbed and uninhabited Ballestas Islands for the chance to spot rare marine birds and mammals



#### ARICA

Take in the iconic view of the Pomerape and Parinacota volcanoes across Chungara Lake in Lauca National Park



#### IQUIQUE

Explore the abandoned mining town of Humberstone in the Atacama Desert, a UNESCO World Heritage site



#### ISLA PAN DE AZUCAR

Look out for Humboldt penguins and other local wildlife as we explore the shores of Isla Pan de Azúcar

PACIFIC OCEAN

Callao (Lima)

Pisco

Matarani

Arica

Iquique

Antofagasta

Isla Pan de Azucar

Coquimbo

Valparaíso

PERU

BOLIVIA

CHILE

ARGENTINA

This varied itinerary offers a little bit of everything, ideal for those that love to keep things interesting. You'll experience the very best of this incredible stretch of the Pacific coastline – from rare marine birds and mammals, stunning volcanoes and desert scenery, to the chance to explore a UNESCO World Heritage site in the Atacama Desert.

Day	Visiting
1	Valparaíso
2	Coquimbo
3	Isla Pan de Azucar
4	Antofagasta
5	At Sea
6	Iquique
7	Arica
8	Matarani
9	At Sea
10	Pisco
11	Callao (Lima)

Itineraries are correct at time of going to print and maybe subject to change.



Lima, Peru

# South American Wildlife & Archaeology

PERU, ECUADOR & PANAMA

On this 12-day expedition cruise you'll experience the planet's most diverse wildlife and meet some of the world's most remote people. This is in addition to exploring vibrant cosmopolitan cities and discovering some of Central America's best-preserved archaeological sites certainly makes for an unforgettable adventure.

**Sailing on**

15th March 2022

**Returns on**

26th March 2022

**Duration**

12 days

**Sailing from**

• Callao (Lima), Peru

**Sailing to**

• Fuerte Amador (Panama City)

**Ship**

SH Minerva



Huaca del Sol, Peru





Panama City



Blue-footed Booby

Observe the famous blue-footed booby and many other local species, discover the pre-Incan relics of Peru's Moche civilisation, learn about the dark history of Colombia's most important eco-sanctuary and experience the lives of the remote indigenous Emberà as they welcome you into their community. This fascinating sailing offers a truly unique mix of culture and nature.

Day	Visiting
1	Callao (Lima)
2	Isla Guanape
3	Salaverry
4	Lobos de Tierra (Cruise)
5	Machala
6	Isla de la Plata
7	Gorgona Island
8	Utria National Park
9	Bahia Solano
10	Darien Jungle
11	Isla del Rey
12	Fuerte Amador (Panama City)

Itineraries are correct at time of going to print and maybe subject to change.



# Gems of Central America

## PANAMA TO GUATEMALA

Experience paradise for yourself on this sublime 13-day expedition cruise. Walk on some of the world's most beautiful beaches, explore straight-out-of-a-storybook tropical islands and visit the most biodiverse areas on the planet. This is an unmissable adventure for wildlife enthusiasts.

**Sailing on**  
26th March 2022

**Returns on**  
7th April 2022

**Duration**  
13 days

**Sailing from**  
Fuerte Amador (Panama City)

**Sailing to**  
Puerto Quetzal, Guatemala

**Ship**  
SH Minerva







Ancient Ruins of Mayan Farm Houses  
in Joya De Ceren, El Salvador



Peak point in San Juan del Sur



Toucan



Coiba Island



Sloth, Quepos

You'll also encounter some of the best examples of colonial architecture in Latin America when we visit Granada and León. Discover the region's ancient history on a visit to the World Heritage Site of Joya de Cerén. You'll take on this incredible journey aboard your boutique cruise ship, enjoying every moment in style and comfort.

Day	Visiting
1	Fuerte Amador (Panama City)
2	Contadora Island
3	Coiba Island
4	Golfito (for Golfo Dulce) & Casa Orquideas
5	Quepos
6	Curu Wildlife Refuge & Isla Tortuga
7	Flamingo
8	San Juan del Sur
9	Corinto
10	Amapala
11	La Union
12	Acajutla
13	Puerto Quetzal

Itineraries are correct at time of going to print and maybe subject to change.



# Mexico Pacific Coast Wonders

GUATEMALA & MEXICO

Visit some of the world's best and most renowned beach resorts as you cruise along the lively Mexican coast.

**Sailing on**  
7th April 2022

**Returns on**  
16th April 2022

**Duration**  
10 days

**Sailing from**  
• Puerto Quetzal, Guatemala

**Sailing to**  
• Mazatlán, Mexico

**Ship**  
SH Minerva







Monte Alban



Puerto Vallarta



Cascadas Magicas de Copalitilla waterfalls



Cacao plantations, Mexico



Surfer, Zihuatenejo

From the surfing capital of Puerto Escondido to the glamorous Acapulco, you'll have a difficult time choosing your favourite seaside spot on this 10-day cruise. Beyond the seafood and picture-perfect beaches, you'll visit fascinating pre-Hispanic archaeological sites, explore bustling market towns and venture out on expert-led wildlife and birdwatching tours. All whilst spending time aboard your boutique cruise ship complete with world class facilities and knowledgeable expedition team.

Day	Visiting
1	Puerto Quetzal
2	Puerto Chiapas
3	Salina Cruz
4	Huatulco
5	Puerto Escondido
6	Acapulco
7	Zihuatenejo
8	Manzanillo
9	Puerto Vallarta
10	Mazatlan

Itineraries are correct at time of going to print and maybe subject to change.



# Natural wonders of Baja California

MEXICO TO THE UNITED STATES

Explore the Sea of Cortez on this 11-day expedition cruise and experience the rich, natural wonders of Baja, California.

**Sailing on**  
16th April 2022

**Returns on**  
26th April 2022

**Duration**  
11 days

**Sailing from**  
• Mazatlán, Mexico

**Sailing to**  
• San Diego, USA

**Ship**  
SH Minerva



Whale Shark





Explore uninhabited islands, hike across volcanic landscapes and craggy coastlines and wander along secluded shorelines. You'll snorkel crystal clear waters where you'll meet shoals of colourful reef fish and curious sea lions. Join experts in our zodiac boats to look-out for marine life. As we cruise this marine paradise, enjoy incredible evening sunsets and say hello to curious dolphins from the comfort of your boutique expedition ship.



Day	Visiting
1	Mazatlán
2	Los Islotes and Espiritu Santo
3	Isla San Pedro
4	Isla Partida & San Esteban
5	Isla Santa Catalina
6	Isla San Jose (Cruise) & Isla San Francisco
7	Topolobampo, Sinaloa
8	Cabo San Lucas
9,10	At Sea
11	San Diego

Itineraries are correct at time of going to print and maybe subject to change.

# UK & Northern French Coast Highlights

## LONDON TO DUBLIN

From culture-crammed cities to candy-coloured ports and towering cliffs, the coastline of the British Isles is strewn with underrated treasures that are just waiting to be discovered.

### Sailing on

16th April 2022

### Returns on

26th April 2022

### Duration

11 days

### Sailing from

● Portsmouth, United Kingdom

### Sailing to

● Dublin, Ireland

### Ship

SH Vega

Explore the idyllic outline of England, Ireland, Scotland and Wales – as well as the semi-autonomous island that sits at their juncture, the Isle of Man. Across the channel on Northern France's coast, visit lively fishing ports and places so beautiful that the Impressionists committed them to canvas. Travel in style and comfort, aboard a brand-new ship crewed by a passionate and knowledgeable team.

Day	Visiting
● 1	Portsmouth
● 2	Honfleur
● 3	St Peter Port
● 4	Fowey
● 5	Scilly Isles (Tresco / St Marys)
● 6	Pembroke (Skomer Island)
● 7	Holyhead
● 8	Iona & Lunga
● 9	Tobermory
● 10	Portrush
● 11	Dublin

Itineraries are correct at time of going to print and maybe subject to change.



Fowey, England



River Liffey, Dublin





Sunset on the Scilly Isles



Portrush, Ireland



Puffin, Iona & Lunga



#### DUBLIN

Delve into the legendary culture and craic of the Republic of Ireland's capital – It's lively, complex, cosmopolitan and eminently walkable.



#### IONA & LUNGA

Seek spiritual sustenance in the Inner Hebrides' intriguing islands. Iona is famed for its abbey, founded in 563 CE – it was here that the sacred treasure, the Book of Kells, was created.



#### ISLES OF SCILLY

Revel in the Scillies' Caribbean-esque sand-rimmed isles and turquoise waters. The world-famous Tresco Abbey Garden with its 20,000 plant species is worth a visit.

ATLANTIC OCEAN

NORTH SEA

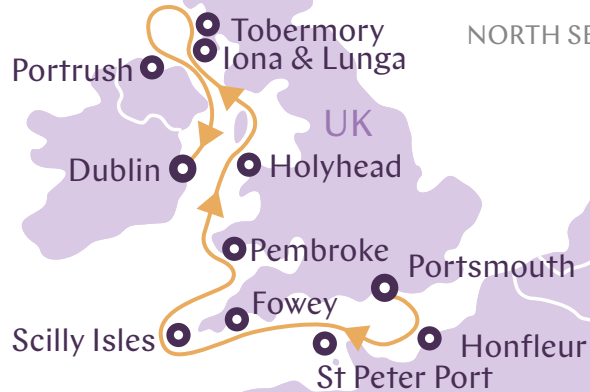



# Islands of Scotland

DUBLIN TO LEITH, EDINBURGH

Sail on a remarkable cruise to the Republic of Ireland, Northern Ireland and Scotland. Explore culture-crammed cities, natural marvels and fascinating ruins that predate Giza's pyramids and Stonehenge.

**Sailing on**

[26th April 2022](#)

**Returns on**

[6th May 2022](#)

**Duration**

[11 days](#)

**Sailing from**

• [Dublin, Ireland](#)

**Sailing to**

• [Leith \(Edinburgh\), Scotland](#)

**Ship**

SH Vega



Monastery, Iona



Visit iconic sites and lesser-known gems, bookended by Dublin's street scenes and Edinburgh's city views. In between, experience Hebridean tranquillity: the Norse traditions of the Shetlands, Scotland's castle country. Sample Islay's celebrated single malts as you immerse yourself in the British Isles' exciting flora and fauna – observe seals and colonies of puffins and guillemots, at home in this otherworldly landscape.

Day	Visiting
1	Dublin
2	Portrush
3	Gigha & Islay
4	Iona & Lunga
5	Stornoway
6	St Kilda
7	Stromness
8	Lerwick
9	Peterhead
10	Berwick upon Tweed
11	Leith (Edinburgh), Scotland

Itineraries are correct at time of going to print and maybe subject to change.



Leith (Edinburgh), Scotland



Seal pup, Farne Islands



Islay, Inner Hebrides

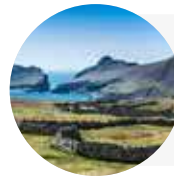

#### ST KILDA

Named one of the most beautiful places in Europe by Condé Nast Traveller, who revered the UNESCO World Heritage Site for its 'unforgettable ocean views and unique ecosystem'.



#### ISLAY

This South Hebrides island is famous for its eight whisky distilleries, stunning coastlines and fabulous bird populations.

# US West Coast Exploration

UNITED STATES TO CANADA

Sail from sunny San Diego to cosmopolitan Vancouver on this 11-day cruise, exploring the Pacific North American coastline.

**Sailing on**

27th April 2022

**Returns on**

6th May 2022

**Duration**

10 days

**Sailing from**

• San Diego, USA

**Sailing to**

• Vancouver, Canada

**Ship**

SH Minerva

San Francisco, California





Portland, Oregon



Vancouver, Canada

You'll discover the unique ecosystems of Santa Cruz Island, part of California's Channel Islands National Park. Indulge your senses in fabulous San Francisco before exploring quirky Portland. Search for wildlife in Olympic National Park, a UNESCO biosphere reserve. Cruise the San Juan islands, a haven for marine mammals before concluding this Pacific adventure in the mountain-framed metropolis of Vancouver.

Day	Visiting
1	San Diego
2	Santa Cruz Island
3	Monterey
4	San Francisco, California
5	At Sea
6	Astoria, Oregon
7	Portland, Oregon & Multnomah Falls
8	At Sea
9	Deception Pass (Cruise) & San Juan Islands
10	Vancouver

Itineraries are correct at time of going to print and maybe subject to change.



# North Atlantic Island Hopping

## SCOTLAND TO ICELAND VIA THE FAROE ISLANDS

Journey through Europe's most remote and remarkable islands, where you'll discover legends, ancient history and unrivalled beauty. There's a wealth of modern culture to be found in cosmopolitan cities too.

**Sailing on**  
6th May 2022

**Returns on**  
16th May 2022

**Duration**  
11 days

**Sailing from**  
● Leith (Edinburgh), Scotland

**Sailing to**  
● Reykjavik, Iceland

**Ship**  
SH Vega

Cruise in comfort and style through the natural beauty of the world's most incredible island destinations. Fall deeply in love with their misty mysticism as you wander through awe-inspiring archaeological ruins. These are ancient places, where the awesome power of nature is revered, and guests are made incredibly welcome.

Day	Visiting
● 1	Leith (Edinburgh), Scotland
● 2	Aberdeen
● 3	Stromness
● 4	Lerwick
● 5	Tórshavn
● 6,7	Djupivogur
● 8	Husavik
● 9	Akureyri
● 10	Ísafjörður & Vígur Island
● 11	Reykjavik

Itineraries are correct at time of going to print and maybe subject to change.



Dunnottar Castle, Aberdeenshire



Stromness, Orkney





Godafoss waterfall  
near Akureyri



Eruption of Geyser, Iceland



Tórshavn, Faroe Islands





# Inside Passage Discovery

VANCOUVER TO SEWARD

Follow in the footsteps of Captain George Vancouver as you make this intrepid journey from Vancouver to Seward.

**Sailing on**

6th May 2022

**Returns on**

16th May 2022

**Duration**

11 days

**Sailing from**

● Vancouver, Canada

**Sailing to**

● Seward, Alaska

**Ship**

SH Minerva



Mother Bear and Cub





Cruise through other-worldly fjords and passages, immerse yourself in the Gold-Rush-era history, come face to face with imposing glaciers and become acquainted with the area's rich indigenous history. You will also have plentiful opportunities to spot wildlife including bears, whales, harbour seals and porpoises. Our on-board expedition team will be on hand to ensure that you don't miss a wildlife spotting opportunity.

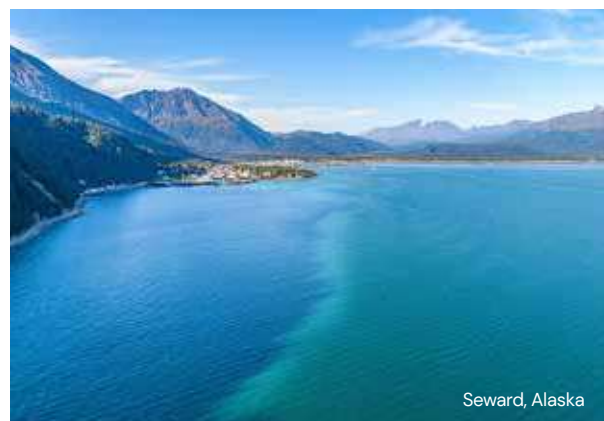

Day	Visiting
1	Vancouver
2	Johnstone Strait
3	Metlakatla
4	Misty Fjords
5	Clover Pass
6	Wrangell Narrows, Petersburg & Sail Island
7	Endicott Arm & Stephens Passage
8	Tenakee Springs & Point Adolphus
9	Hubbard Glacier
10	At Sea
11	Seward

Itineraries are correct at time of going to print and maybe subject to change.

# Japan & Micronesia Discovery

## OTARU TO GUAM

Explore Japan's traditions, culture and nature from Hakodate to Yokohama, before veering off the beaten track to visit the Pacific idylls of some of America's oceanic territories.

**Sailing on**  
10th September 2022

**Returns on**  
24th September 2022

**Duration**  
15 days

**Sailing from**  
Otaru, Japan

**Sailing to**  
Guam, Micronesia

**Ship**  
SH Minerva







Yakushima Island



Matsue, Japan



Sasebo, Japan



Otaru, Japan



Kanazawa Station, Japan

Set out on a sweeping cruise aboard a luxurious ship through one breathtaking destination after another. Japan's historic cities like Otaru and beautiful subtropical islands like Chichijima are little-visited but much-loved by travellers in the know. Pacific Islands Saipan and Guam are more well-known, and for good reason. From neon-lit cities to white sands, forest-topped islands and sapphire waters, you'll experience it all on this perfectly curated journey.

Day	Visiting
1	Otaru
2	At Sea
3	Sado Island (Ogi)
4	Kanazawa
5	Sakaiminato (for Matsue)
6	Hagi
7	Sasebo
8	Yakushima Island (Miyanoura)
9	At Sea
10	Chichi-jima
11	At Sea
12	Maug Islands
13	Pagan
14	Saipan
15	Guam

Itineraries are correct at time of going to print and maybe subject to change.



# Micronesia & Melanesia Discovery

## GUAM TO LAUTOKA

An extraordinary cruise through some of the most exclusive destinations in the world. Micronesia and Melanesia offer a taste of paradise, with beautiful bays, beaches, reefs, and shipwrecks to explore – all set against a backdrop of remarkable history and culture.

**Sailing on**  
24th September 2022

**Returns on**  
12th October 2022

**Duration**  
19 days

**Sailing from**  
Guam, Micronesia

**Sailing from**  
Lautoka, Fiji

**Ship**  
SH Minerva



### LAMOTREK

Enjoy the famously warm welcome of the Yapese and learn all about their lives and culture, all while enjoying glistening lagoon views.

### RODERICK BAY

This hidden cove houses the shipwrecked remains of the World Discoverer: snorkel around the wreck and marvel at the ocean life.

### NJARI ISLAND

One of the most thrilling snorkelling and diving sites we've come across, enjoy a day on this almost completely secluded island.





Masks of Rabaul Festival



Riri River, Espiritu Santo



Tegua Island, Vanuatu

'Idyllic' takes on new meaning in these subregions of Oceania: from Guam, Yap, Papua New Guinea, and the Solomon Islands to the Floridas, Vanuatu and the islands of Fiji, these remote islands are little spots of heaven strewn across thousands of kilometres of the Pacific Ocean. Experience the cultures that form the beating heart of each region, and you'll understand the true meaning of hospitality.

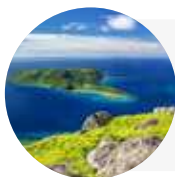

#### YASAWA

Visit the village of Nabukera to meet the islanders, offering first a tangled bundle of kava roots as a gesture of respect.

Day	Visiting
1	Guam
2	Gaferut, Yap
3	Lamotrek, Yap
4	Satawal, Yap
5	At Sea
6	Tingwon
7	Rabaul
8	At Sea
9	Njari Island
10	Roderick Bay
11	Santa Ana Island
12	At Sea
13	Ureparapara, Divers Bay
14	Tegua Island
15	Champagne Beach & Paradise Lagoon
16	Ambrym Island
17	At Sea
18	Nabukeru, Yasawa
19	Lautoka

Itineraries are correct at time of going to print and maybe subject to change.

- Nabukeru, Yasawa
- Lautoka



# South Pacific Odyssey

## FIJI TO TAHITI

Nothing can prepare you for the beauty of the South Pacific. Discover the striking vistas of tropical landscapes and the diverse ecosystems that thrive here, in one of Earth's true idylls.

**Sailing on**  
12th October 2022

**Returns on**  
24th October 2022

**Duration**  
14 days

**Sailing from**  
• Lautoka, Fiji

**Sailing to**  
• Papeete, Tahiti

**Ship**  
SH Minerva

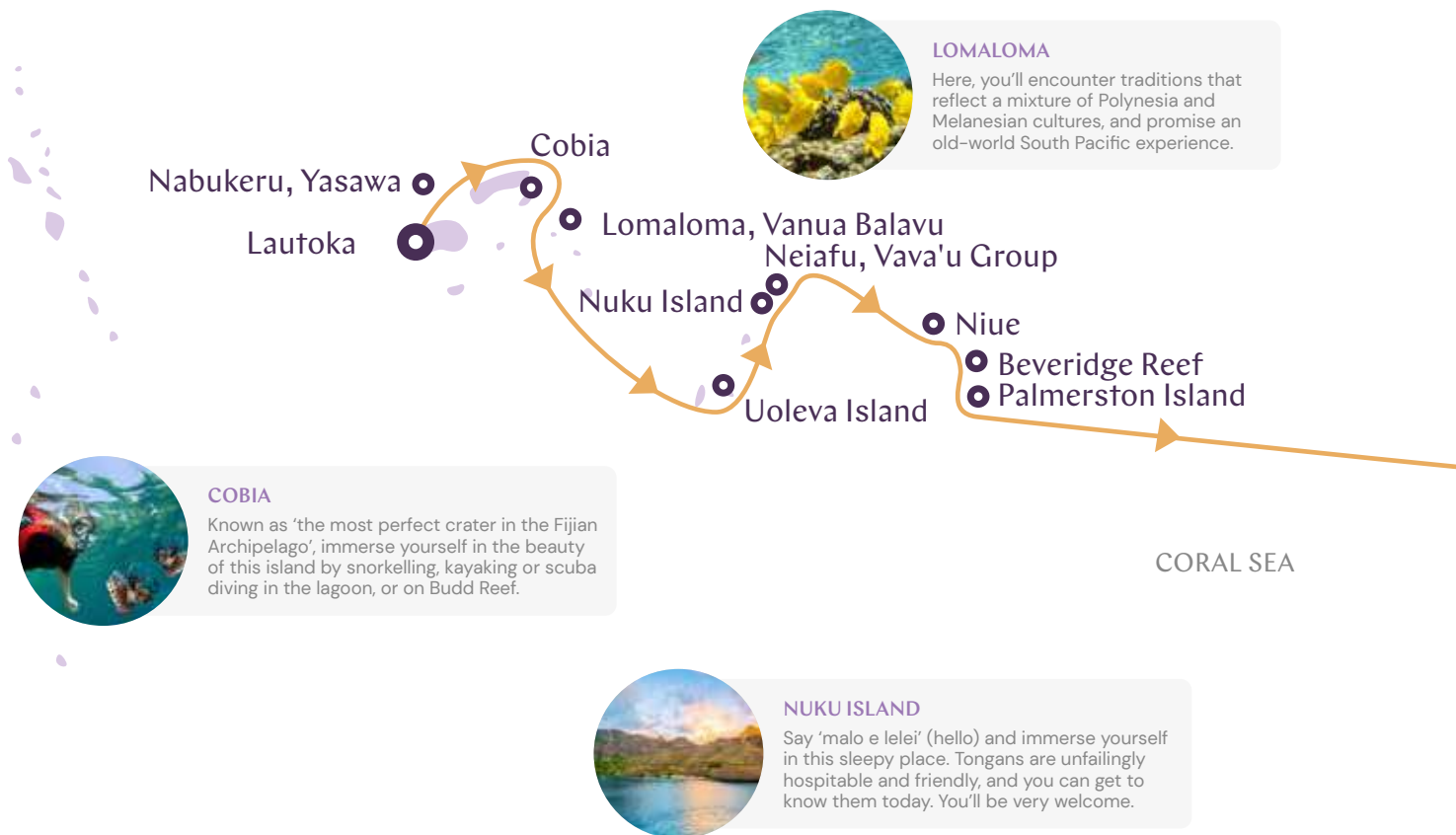





Mount Otemanu, Bora Bora



Green Turtle



Papeete Harbour

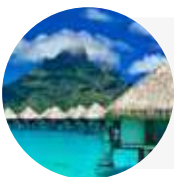

#### BORA BORA

This is a South Pacific dream come to life: enjoy the island's pristine palm-lined beaches scented by tiare flowers, views of iconic Mounts Pahia and Otemanu, and electric-blue lagoons.

Sail past Fiji, Tonga, Niue, the Cook Islands and French Polynesia along the way: on this voyage, nearly every day brings a new island and a new adventure. Explore coral reefs, see thriving marine ecosystems, hike on forested volcanic peaks, and learn about local history and cultures on engaging shore excursions.

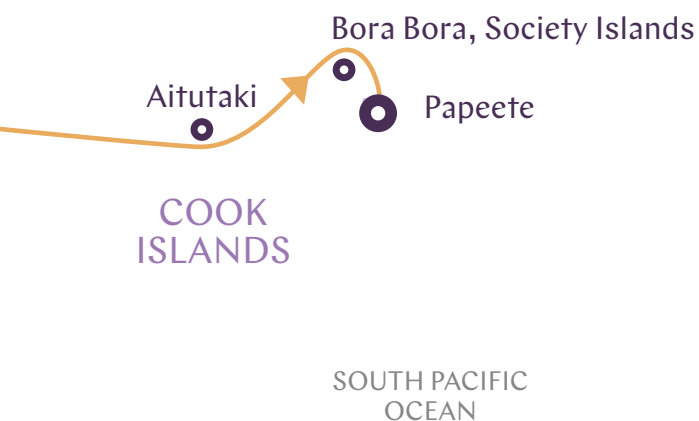

Day	Visiting
1	Lautoka
2	Nabukeru
3	Cobia
4	Lomaloma
5	At Sea
6	Uoleva Island
7	Nuku Island & Neiafu, Vava'u Group
8	Niue
9	Beveridge Reef
10	Palmerston Island
11	Aitutaki
12	At Sea
13	Bora Bora
14	Papeete

Itineraries are correct at time of going to print and maybe subject to change.



# The Caribbean & North Brazil Discovery

ST MAARTEN TO SALVADOR DE BAHIA

Embark on an odyssey to a part of the world that defies definition, where pristine white sand and shimmering crystalline seas meet fascinating cultural traditions and sites of historic importance.

**Sailing on**  
15th October 2022

**Returns on**  
3rd November 2022

**Duration**  
20 days

**Sailing from**  
• St Maarten, Caribbean

**Sailing from**  
• Salvador de Bahia, Brazil

**Ship**  
SH Vega



Pelourinho, Salvador de Bahia



Explore iconic sights as well as lesser-known gems. Trace a colonial past and discover an enthralling present. From Sint Maarten in the Lesser Antilles, travel with us to a handpicked selection of the southern hemisphere's most vibrant, culturally rich destinations – starting at Macapá, at the mouth of the Amazon.

Day	Visiting
1	St Maarten
2	Îles des Saintes
3	Bequia
4	Scarborough
5	At Sea
6	Georgetown
7	Paramaribo
8,9	Îles Du Salut
10	At Sea
11	Macapá
12,13	At Sea
14	Sao Luis
15	At Sea
16	Fortaleza
17	At Sea
18	Recife
19	At Sea
20	Salvador de Bahia



Bequia



Philipsburg, St Maarten

Itineraries are correct at time of going to print and maybe subject to change.



# French Polynesia & South Pacific Discovery

## TAHITI TO EASTER ISLAND

The silhouette of a moai statue set against a sunset. The intense blue of a languid lagoon. The night sky, filled with South Seas stars. Paradise lives in the Pacific, and you're sure to find it as you journey with us.

**Sailing on**  
24th October 2022

**Returns on**  
9th November 2022

**Duration**  
17 days

**Sailing from**  
• Papeete, Tahiti

**Sailing to**  
• Easter Island, Chile

**Ship**  
SH Minerva

### Explore Robinson Crusoe Island

Combine this sailing with our Easter Island 7 day trip to enjoy extra time exploring this incredible region, calling at Robinson Crusoe Island and ending in Valparaiso, Chile.







Anakena Beach, Easter Island



Papeete Harbour



Motu Vaiamanu



#### HENDERSON

The location of a famous whaling shipwreck that inspired Herman Melville's Moby Dick, this island gem is listed as a UNESCO World Heritage Site.

• Ducie

Easter Island



#### EASTER ISLAND

Easter Island's monolithic moai are sublime. Carved out of volcanic rock between the 10th and 16th centuries by Polynesian settlers, these statues are famed all over the world.

French Polynesia and South Pacific are the object of many a travel fantasy. It can be no surprise that the Bounty mutineers chose this spot in which to rebel and then hide from the British Navy. On this extended cruise, you'll travel from Tahiti in French Polynesia to the Austral and Bass Islands. Then it's onwards toward the beautiful Pitcairns, which benefit from their association with the Bounty. Your journey's end is Rapa Nui, a small island that's big on cultural mysteries.

Day	Visiting
1	Papeete
2	At Sea
3	Motu Vaiamanu
4,5	Rapa
6	Marotiri Islands
7,8	At Sea
9	Oeno
10	Adamstown
11	Henderson
12	Ducie
13,14	At Sea
15-17	Easter Island

Itineraries are correct at time of going to print and maybe subject to change.



# South America East Coast Discovery

BRAZIL, URUGUAY & ARGENTINA

Trace the southeastern coast of South America on a captivating cruise that spans three countries, eight ports and one coral-fringed atoll. Experience the passion, rhythm and romance that drives life and culture of this fascinating continent.

**Sailing on**

3rd November 2022

**Returns on**

16th November 2022

**Duration**

14 days

**Sailing from**

• Salvador de Bahia, Brazil

**Sailing to**

• Buenos Aires, Argentina

**Ship**

SH Vega

Christ the Redeemer  
overlooking Rio De Janeiro





Cruise aboard your über-elegant ship along Brazil's verdant shoreline, home to one of the most vibrant ecosystems on the planet. Venture on to Uruguay – South America's little-known cultural hub – before crossing the River Plate to your final destination: Argentina's Buenos Aires. Queen of the Plate, the Paris of the South, Tangopolis – these romantic monikers reveal a deep love for the city that is sure to set your heart alight.



Day	Visiting
1	Salvador de Bahia
2	Porto Seguro
3	Abrolhos Archipelago
4	At Sea
5,6	Rio de Janeiro
7	Paraty
8	Santos
9	Portobelo
10,11	At Sea
12	Montevideo
13,14	Buenos Aires

Itineraries are correct at time of going to print and maybe subject to change.

# Moais Mythology & Castaways

## EASTER ISLAND TO VALPARAISO

Discover some of the world's most remote islands on this 9-day expedition cruise.

### Sailing on

9th November 2022

### Sailing from

• Easter Island, Chile

### Returns on

17th November 2022

### Sailing to

• Valparaíso, Chile

### Duration

9 days

### Ship

SH Minerva

Begin your exploration by getting acquainted with Easter Island's famous moai before setting off to spend some time on the wild and uninhabited Isla Salas y Gomez. If you don't feel like you're aboard the last ship on earth at this point, you certainly will as we make our way across 1400 nautical miles of ocean to arrive at the island where Scottish sailor Alexander Selkirk was marooned for over four years. Meet the people who carve out a living in this far corner of the world and observe the extraordinary wildlife that thrives here. Conclude this wonderful adventure in the bustling city of Valparaíso, enjoying all the culinary and cultural delights on offer.

Day	Visiting
1	Easter Island
2	Isla Salas y Gomez
3-6	At Sea
7	Robinson Crusoe Island
8	At Sea
9	Valparaíso

Itineraries are correct at time of going to print and maybe subject to change.

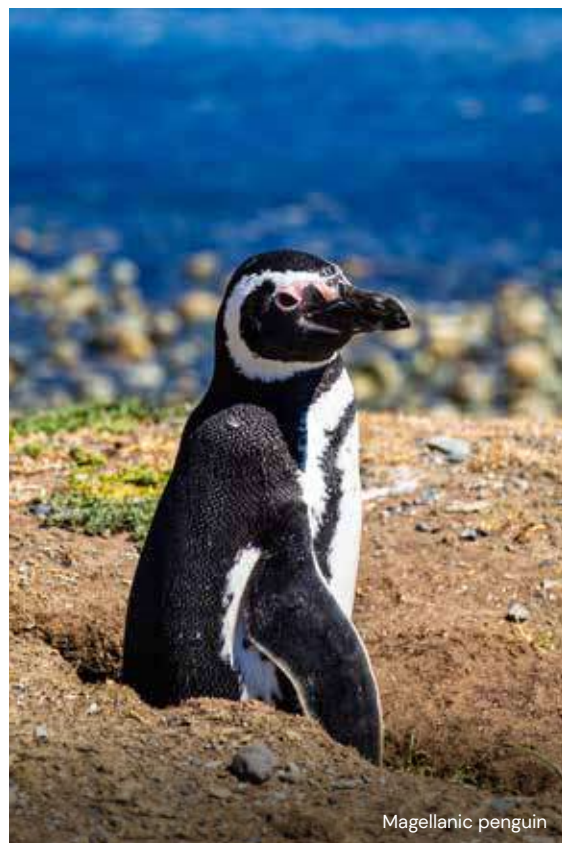

Magellanic penguin





Standing moai, Easter Island



Robinson Crusoe Island



Vineyards at Casablanca, Valparaíso



#### EASTER ISLAND

Come face to face with Easter Island's famous carvings (moai)



#### ROBINSON CRUSOE ISLAND

Follow in the footsteps of castaway sailor Alexander Selkirk on a visit to Robinson Crusoe Island



#### ISLA SALAS Y GOMEZ

Explore the uninhabited Isla Salas y Gomez, observing the local and unique wildlife



#### VALPARAÍSO

Enjoy Valparaíso's bustling and colourful city life

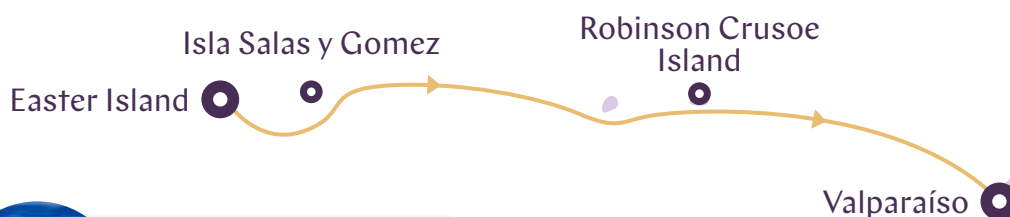

SOUTH  
PACIFIC  
OCEAN

CHILE

ARGENTINA



# Jewels of the Chilean Fjord

CHILE & ARGENTINA

Explore dramatic fjords, towering glaciers and of course meet the mighty condor as you traverse the bottom of the world on this 14-day Chilean Fjords cruise.

**Sailing on**  
17th November 2022

**Returns on**  
30th November 2022

**Duration**  
14 days

**Sailing from**  
Valparaíso, Chile

**Sailing to**  
Ushuaia, Argentina

**Ship**  
SH Minerva



Andean Condor





#### ISLA MOCHA

Enjoy the natural serenity of Isla Mocha, a nature protected island with wildlife as fascinating as its colourful human history



#### PUERTO MONTT

Spend time in Chile's oldest national park, Pérez Rosales, on your trip to the vibrant and thundering Petrohué rapids, located at foot the iconic Osorno Volcano

#### SOUTH PACIFIC OCEAN



#### PIO XI GLACIER

Experience the thundering sound of calving ice as you approach the immense PIO XI glacier, one of world's only advancing glaciers



#### PUERTO NATALES

Come face to face with the imposing and famed trio of granite pillars as you explore the renowned Torres del Paine National Park



#### GARIBALDI GLACIER

Visit Garibaldi Glacier, considered one of Chile's most beautiful glaciers, as you cruise through the pristine Alberto de Agostini National Park



Tortel, Chile



Torres del Paine National Park

Set sail from the vibrant historical city of Valparaíso, stopping at charming coastal settlements as you make your way south towards the granite pillars of Torres del Paine National Park. From here begin your exploration of some of the biggest, best-known, and most interesting fjords and glaciers in the southern hemisphere. Your knowledgeable on-board experts will assist you on your search for local wildlife including the famed Andean condor, as well as answer any questions you may have about your out-of-this-world surroundings.

Day	Visiting
1	Valparaíso
2	Isla Mocha
3	At Sea
4	Puerto Montt
5	Castro
6	At Sea
7	Tortel
8	Pio XI Glacier (Cruising)
9	Fjords (Cruising)
10,11	Puerto Natales
12	Fjords (Cruising)
13	Garibaldi Glacier (Cruising)
14	Ushuaia

Itineraries are correct at time of going to print and maybe subject to change.

## DECK PLANS

# SH Minerva & SH Vega

Our elegant 5-star ships offer a boutique home-from-home, with chic Scandinavian-inspired design perfectly paired with world-class technology to offer you an expedition cruise like no other.

## Stateroom Category:

Oceanview:	16 (19m <sup>2</sup> )	○
Balcony:	54 (28m <sup>2</sup> )	●
Suite:	4 (44m <sup>2</sup> )	●
Premium Suite:	2 (49m <sup>2</sup> )	●

## Ship Specification:

Guest Capacity:	152
Staff:	120
No. of Decks:	9
Length:	337ft (115m)
Breadth:	75ft (23m)
Tonnage:	10,500
Cruising Speed:	15.5 knots
Propulsion:	Hybrid Diesel Electric, Polar Class PC5
Registered:	Malta
Lifeboats:	2
Zodiacs:	11 MK V 2 MK VI





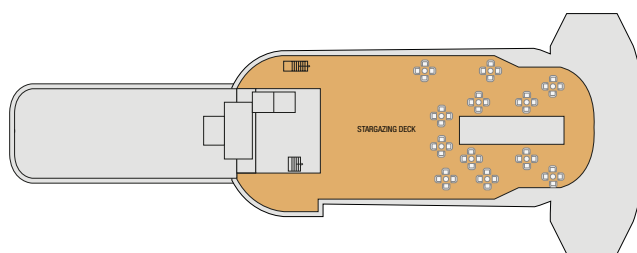

Deck 9  
Stargazing Deck

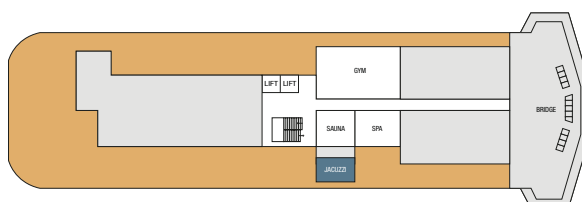

Deck 8  
Gym  
Sauna  
Jacuzzi  
Spa  
Bridge

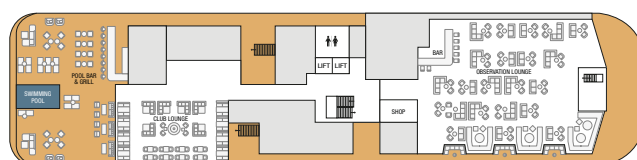

Deck 7  
Shop  
Swimming pool  
Pool Bar & Grill  
Club Lounge  
Observation Lounge



Deck 6  
Premium Suites  
Suites  
Balcony Staterooms  
Swan's Nest

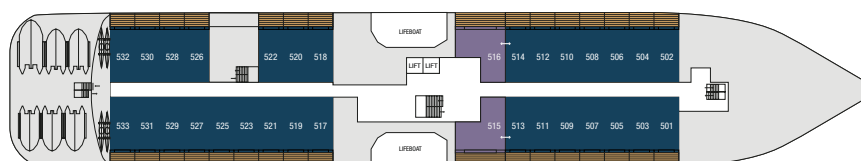

Deck 5  
Balcony Staterooms  
Suites



Deck 4  
Reception  
Laundrette  
Swan Restaurant  
Oceanview Staterooms

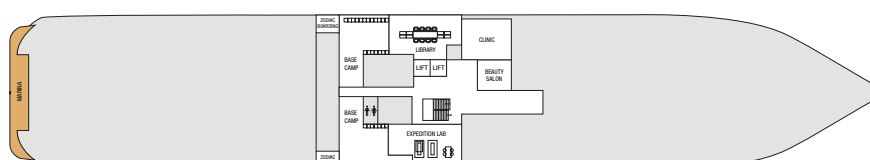

Deck 3  
Clinic  
Library  
Basecamp  
Beauty Salon  
Expedition Lab

# Itinerary Summary

ITINERARY	DURATION	SHIP	SAILING DATES	PAGE
<b>ANTARCTICA</b>				
ANTARCTIC SOLAR ECLIPSE	12 Days	SH Minerva	30/11/21	24–25
CLASSIC ANTARCTICA	10 Days	SH Minerva	12/12/21	26–27
ANTARCTICA IN DEPTH	16 Days	SH Minerva	22/12/21	28–29
FALKLANDS & ANTARCTIC PENINSULA	13 Days	SH Minerva	07/01/22 & 08/02/22	30–31
ANTARTICA ENCOMPASSED	11 Days	SH Minerva	19/01/22 & 29/01/22	32–33
SHACKLETON'S DISCOVERY	22 Days	SH Vega	16/11/22	34–35
<b>ARCTIC</b>				
ICELAND CIRCUMNAVIGATION	8 Days	SH Vega	16/05/22	38–39
ARCTIC DISCOVERY	14 Days	SH Vega	23/05/22	40–41
SVALBARD ENCOMPASSED	8 Days	SH Vega	05/06/22 & 12/06/22	42–43
SVALBARD IN DEPTH (LONGYEARBYEN TO TROMSO)	11 Days	SH Vega	19/06/22	44–45
SVALBARD IN DEPTH (TROMSO TO LONGYEARBYEN)	11 Days	SH Vega	29/06/22	46–47
ARCTIC DISCOVERY (SVALBARD, FRANZ JOSEF LAND & NOVALIA ZEMLYA)	20 Days	SH Vega	09/07/22	48–49
ARCTIC IN DEPTH (SIBERIA TO NORWAY)	16 Days	SH Vega	28/07/22	50–51
ARCTIC EXPLORER (FRANZ JOSEF LAND, SPITSBERGEN & ICELAND)	19 Days	SH Vega	12/08/22	52–53
GREENLAND DISCOVERY: WEST GREENLAND	11 Days	SH Vega	30/08/22	54–55
CANADIAN ARCTIC DISCOVERY	17 Days	SH Vega	09/09/22	56–57
NORTHERN CANADA DISCOVERY	16 Days	SH Vega	25/09/22	58–59
<b>RUSSIAN FAR EAST</b>				
KAMTCHATKA & ALEUTIAN ISLANDS DISCOVERY (SEWARD TO OTARU)	19 Days	SH Minerva	17/05/22	62–63
RUSSIA'S RING OF FIRE	11 Days	SH Minerva	05/06/22	64–65
KAMTCHATKA & ALEUTIAN ISLANDS DISCOVERY (OTARU TO SEWARD)	20 Days	SH Minerva	15/06/22	66–67
ALEUTIAN ISLANDS, RUSSIAN FAR EAST & BERING SEA DISCOVERY	17 Days	SH Minerva	03/07/22	68–69
FAR EAST ARCTIC HIGHLIGHT	15 Days	SH Minerva	19/07/22	70–71
FAR EAST ARCTIC IN DEPTH	19 Days	SH Minerva	02/08/22	72–73
JOURNEY ACROSS THE BERING SEA	21 Days	SH Minerva	20/08/22	74–75
<b>REST OF THE WORLD</b>				
IN THE WAKE OF DARWIN'S HMS BEAGLE	14 Days	SH Minerva	20/02/22	78–79
DESERTS OF THE PACIFIC COASTLINE	11 Days	SH Minerva	05/03/22	80–81
SOUTH AMERICAN WILDLIFE & ARCHAEOLOGY	12 Days	SH Minerva	15/03/2022	82–83
GEMS OF CENTRAL AMERICA	13 Days	SH Minerva	26/03/2022	84–85
MEXICO PACIFIC COAST WONDERS	10 Days	SH Minerva	07/04/2022	86–87
NATURAL WONDERS OF BAJA CALIFORNIA	11 Days	SH Minerva	16/04/2022	88–89
UK & NORTHERN FRENCH COAST HIGHLIGHTS	11 Days	SH Vega	16/04/2022	90–91
ISLANDS OF SCOTLAND	11 Days	SH Vega	26/04/2022	92–93
US WEST COAST EXPLORATION	10 Days	SH Minerva	27/04/2022	94–95
NORTH ATLANTIC ISLAND HOPPING	11 Days	SH Vega	06/05/2022	96–97
INSIDE PASSAGE DISCOVERY	11 Days	SH Minerva	06/05/2022	98–99
JAPAN & MICRONESIA DISCOVERY	15 Days	SH Minerva	10/09/2022	100–101
MICRONESIA & MELANESIA DISCOVERY	19 Days	SH Minerva	24/09/2022	102–103
SOUTH PACIFIC ODYSSEY: FIJI TO TAHITI	14 Days	SH Minerva	12/10/2022	104–105
THE CARIBBEAN & NORTH BRAZIL ODYSSEY	20 Days	SH Vega	15/10/2022	106–107
FRENCH POLYNESIA AND SOUTH PACIFIC DISCOVERY	17 Days	SH Minerva	24/10/2022	108–109
SOUTH AMERICA EAST COAST DISCOVERY	14 Days	SH Vega	03/11/2022	110–111
MOAIS MYTHOLOGY & CASTAWAYS	9 Days	SH Minerva	09/11/2022	112–113
JEWELS OF THE CHILEAN FJORDS	14 Days	SH Minerva	17/11/2022	114–115



# Terms & Conditions

Please read these travel conditions carefully before booking your package tour, because you accept them as binding with your booking.

The following terms and conditions apply to all bookings and, where effectively agreed, govern the contractual relationship between you and Swan Hellenic Travel Ltd. (hereinafter referred to as "Swan Hellenic Travel") in addition to the legal provisions of EU Package Travel Directive respectively the national law implementation of named directive – as here i.e the Cyprus implementation as "The Package Travel and Linked Travel Arrangements Law Number 186(I) of 2017, or respectively the applicable transition of EU directive 2015/2302 into national law for your country, where the travel modules are offered. The travel conditions supplement and complete these. Before concluding a package tour contract, we must inform you about the details of your cruise package tour, which are substantial, as well as about your rights under EU Directive 2015/2302. You can find the information on your package tour in the general and specific service descriptions of our tours and these travel conditions. In addition to your rights under EU Directive 2015/2302, we have included the required form on our website, in your travel agency and in the booking systems in which our trips can be booked. In addition, the General Conditions of Carriage of Passengers and their Luggage by Sea of the Carrier/Shipping Company (conditions of carriage) and the Conditions of Carriage of the Operating Carrier for regular scheduled flights with international airlines apply to flight services. These conditions are available from your travel agent or on request from our call center.

We would like to point out that tour operator within the meaning of the applicable statute as transitional definition of the named EU directive – in the Cyprus "The Package Travel and Linked Travel Arrangements Law 186 (I) of 2017 is exclusively Swan Hellenic Travel Ltd., for all trips offered on the website.

The term "customer" is used below to refer to our contractual partner and the term "traveller" to refer to those persons who actually commence the journey.

We recommend every traveller to take out a travel cancellation insurance, travel interruption insurance and a travel health insurance policy with assumption of the return transport costs of repatriation.

## 1. REGISTRATION AND CONCLUSION OF THE TRAVEL CONTRACT

- 1.1 With the booking (travel registration) the customer bindingly offers Swan Hellenic Travel the conclusion of a travel contract and at the same time confirms to Swan Hellenic Travel the knowledge of the above mentioned pre-contractual information. Registration is possible in writing, by fax or electronically, in exceptional cases also by telephone. It is made by the applicant also for all participants listed in the registration. The basis of this offer is the travel advertisement with all information contained therein, in particular also with regard to offered flight services, as well as these travel conditions.
- 1.2 The package travel contract is concluded exclusively with the written travel confirmation or invoice by Swan Hellenic Travel. The electronic confirmation of receipt of the travel registration as well as a booking form signed at the travel agency, if applicable, do not constitute acceptance of the travel contract. If the travel confirmation is made immediately after pressing the button "Book Now" by the immediate display of the travel confirmation on the screen, the package travel contract is concluded with the display of this travel confirmation. Swan Hellenic Travel is not obliged in case of non-acceptance of the travel request to expressly declare non-acceptance and/or to justify non-acceptance to the customer.
- 1.3 The customer is responsible for all contractual obligations of fellow travellers for whom he makes the booking as for his own, provided that he has assumed this obligation by express and separate declaration.
- 1.4 If the content of the travel confirmation deviates from the content of the registration, Swan Hellenic Travel shall be bound to this new offer for 7 days. The travel contract is concluded on the basis of the new offer if the customer accepts the offer by express declaration, down payment, payment of the balance or commencement of travel within the specified period. According to the legal regulations for cruise package contracts concluded at a distance (e.g. via letters, telephone calls, e-mails, telemedia or online services), there is no right of rescission, but only the legal right of withdrawal and cancellation. However, a right of cancellation exists if the contract for travel services has been concluded outside business premises, unless the negotiations on which the conclusion of the contract is based were based on a previous order by the consumer; in the latter case there is no right of rescission.

## 2. PAYMENT

- 2.1 Swan Hellenic Travel and travel agents may only demand or accept payments on the travel price before the end of the trip, if the security note/ bonding information has been handed over to the customer. After conclusion of the contract, a down payment of 15% of the cruise package price is due upon handing over of the security certificate. The remaining payment is due 60 days before the start of the trip, provided that the security note has been handed over. 2.1 If the customer does not make the down payment and/or the balance payment in accordance with the agreed payment due dates, and if Swan Hellenic Travel is willing and able to properly provide the contractual services, has fulfilled the statutory information obligations and no legal or contractual right of retention exists on your part, Swan Hellenic Travel shall be entitled, in the event of non-performance of the down payment, to withdraw from the package cruise package contract after issuing a reminder setting a deadline and to charge you with the costs of withdrawal in accordance with section 4.2 sentences 2 to 4.4. If the agreed cruise package price has not been paid in full by the due date, Swan Hellenic Travel shall be entitled to terminate the package cruise package contract and to claim damages in the amount of the corresponding cancellation fees, provided that there was not already at that time a package cruise package deficiency justifying cancellation. Swan Hellenic Travel shall be entitled to claim damages for non-performance under the conditions of Cyprus Law or similar national law statutes. If you have booked your trip only 60 days before the start of the trip or later, full payment must be made immediately after receipt of the travel confirmation with security note/ bonding information. With the travel confirmation/ invoice you will receive a security note based on the local law requirements. Swan Hellenic Travel has taken out insolvency bonding according to ACTA Briefing for all cruise only bookings and for all Flight inclusive cruise packages to secure your customer deposits and full payments. The respective local security note securitizes a direct claim against the bonding organization in the event of insolvency of Swan Hellenic Travel and it's address is sent to you with the travel confirmation.

## 3. CHANGES IN PERFORMANCE

- 3.1 The offers and information on the scope of the contractual travel services on our website correspond to the status at the time of publication. The travel prices are based on the current rates of carriage and exchange rates applicable at the time of the travel advertisement. Until the customer's booking request has been transmitted, however, changes to the services/ the scope of services/ the ship route/ the arrival and departure modalities are possible for objectively justified reasons, which is why Swan Hellenic Travel expressly reserves this right. Swan Hellenic Travel will of course inform the customer of these changes prior to the conclusion of the contract or prior to the submission of its binding contractual offer.
- 3.2 Swan Hellenic Travel expressly reserves the right to deviations and changes of individual travel services from the contractually agreed content of the package travel contract, which become necessary after conclusion of the contract, as far as these changes are insignificant according to EU Package Travel Directive in the Cypriot transition or the respective national law statutes in your country where the travel modules are offered. In the case of cruises, changes to the itinerary are possible at any time, e.g. due to official regulations, special circumstances of shipping traffic, medical emergencies,

or if a different itinerary becomes necessary in the interest of the safety of the passengers or for weather reasons or related to national or international epidemic or pandemic rules. The captain responsible for the ship shall decide on such changes to the itinerary and/or travel and layover times that become necessary after conclusion of the contract.

- 3.3 Any warranty claims shall remain unaffected if the changed services are defective.
- 3.4 Swan Hellenic Travel is obliged to inform the customer of significant changes to the contract immediately after becoming aware of the reason for the change.
- 3.5 If Swan Hellenic Travel is only able to provide the booked trip due to a circumstance occurring after conclusion of the contract under significant change of one of the essential characteristics of the travel service, or only under deviation from a contractual agreement made separately between Swan Hellenic Travel and the customer, Swan Hellenic Travel shall be entitled to offer the customer a corresponding contractual change as new offer before commencement of the trip, or optionally also participation in another trip (substitute trip). In such a case, the customer shall have the right to withdraw from the booked trip without payment of compensation, to demand participation in a substitute trip or to accept the new offer to change the contract within 7 days of receipt of our notification of change with the new offer. Swan Hellenic Travel shall expressly inform the customer of this period in the notification of change. Therefore, the offered new contract shall be deemed accepted if the customer does not inform Swan Hellenic Travel within this set period that he wishes to withdraw from the cruise package contract free of charge or demands participation in a substitute cruise package offered. The new offered service shall replace the service originally owed under the contract. Any warranty claims remain unaffected if the new service is defective.

#### 4. CANCELLATION BY THE CUSTOMER BEFORE COMMENCEMENT OF TRAVEL/ CANCELLATION COSTS

- 4.1 The customer can withdraw from the trip at any time before the start of the trip. Cancellation must be made to Swan Hellenic Travel at the address given below. If the trip was booked through a travel agency, the withdrawal can also be declared to this agency. The customer is recommended to declare the cancellation in writing. The date of receipt by Swan Hellenic Travel or the respective travel agency of the notice of withdrawal shall be decisive for the date of withdrawal.
- 4.2 If the customer withdraws before the start of the trip or does not commence the trip, Swan Hellenic Travel loses its claim to the travel price. Swan Hellenic Travel may instead demand reasonable compensation insofar as Swan Hellenic Travel is not responsible for the cancellation or insofar as extraordinary circumstances do not occur at the place of destination or its immediate vicinity which considerably impair the performance of the journey or the carriage of persons to the place of destination; circumstances are unavoidable if they are not subject to the control of Swan Hellenic Travel and their consequences could not have been avoided even if all reasonable precautions had been taken.
- 4.3 The amount of the compensation shall be determined by the travel price less the value of the expenses saved by Swan Hellenic Travel and less what Swan Hellenic Travel acquires through other use of the travel services, which shall be justified by Swan Hellenic Travel at the customer's request. Swan Hellenic Travel has determined the following compensation level schedule taking into account the period between the notice of withdrawal and the commencement of the journey as well as the expected savings of expenses and the expected acquisition through other use of the travel services. The compensation will be calculated as follows with the respective cancellation scale after the date of receipt of the notice of cancellation:

The following cancellation fees apply to all other trips, with the exception of Special Cruise Itineraries:

- A USD 300/ EUR 300/ GBP 300/ CAD 300.00/ AUD 300/ NZD 300 administrative fee is assessed for all cancellations up to 120 days before cruise departure.
- For cancellations 119-60 days prior to departure: 15% of the cruise package price;
- For cancellations 59-30 days prior to departure: 75% of the cruise package price;
- For cancellations 29 days prior to departure: 100% of the cruise package price

In the case of flight tickets for special price conditions which are booked in addition to the cruise arrangement, 100% of the net ticket price will be charged as cancellation fees in the event of cancellation or no show, taxes and fees on the flight ticket will be refunded.

- 4.4 In any case, the customer is at liberty to prove to Swan Hellenic Travel that Swan Hellenic Travel has incurred no damage at all or substantially less damage than the cancellation level demanded by it.
- 4.5 Swan Hellenic Travel reserves the right to demand a higher, concrete compensation instead of the aforementioned cancellation level if Swan Hellenic Travel proves that it has incurred significantly higher expenses than the applicable cancellation level. In this case, Swan Hellenic Travel shall be obliged to quantify and substantiate the claimed compensation taking into account the saved expenses and any other use of the travel services.
- 4.6 The statutory right of the customer to demand from Swan Hellenic Travel in accordance with EU Package Travel Directive in the Cyprus Transition or the respective national law statutes, in your country where the travel modules are offered that a third party takes over the rights and obligations arising from the package travel contract instead of him shall remain unaffected by the above conditions. Until the start of the trip, i.e. taking into account a reasonable period of time for organisational measures which must be reasonable for Swan Hellenic Travel, the customer may demand that a third party takes his place in the rights and obligations arising from the package travel contract. Swan Hellenic Travel may object to the entry of the third party if the third party does not meet the special travel requirements or if its participation is contrary to statutory regulations or official orders. If a third party enters into the contract, he and the customer shall be jointly and severally liable to Swan Hellenic

Travel for the travel price and the additional costs incurred as a result of the entry of the third party, in particular for changing the flight tickets and fees of the respective service providers.

We charge handling fees of €/GBP/USD 50.00 for the transfer of the contract to a substitute person (plus any fees charged by third parties – in particular airlines).

Declarations of withdrawal, rebooking and changes should be made in writing in the interest of the customer and for reasons of proof.

#### 5. REBOOKING

- 5.1 If a customer wishes to rebook for another trip, he should ask Swan Hellenic Travel to clarify whether the request can be met. There is no legal right to rebooking. This does not apply if the rebooking is necessary because Swan Hellenic Travel has not provided the traveller with any, insufficient or incorrect pre-contractual information in accordance with EU Package Travel Directive in the Cyprus transition or the respective national law statutes, in your country where the travel modules are offered; in this case the rebooking is possible free of charge. Otherwise, rebooking is only possible if the rebooking takes place on a trip that begins within six months of the original departure date and is more expensive. Changes can only be made up to 61 days before departure and will only be permitted once. In contrast, changes that only relate to individual travel services (e.g. hotel or flight) as well as pure name corrections that do not represent a change of person are possible at any time before departure. When registering your trip, Swan Hellenic Travel must have your full name with all first names and surnames and the names of all registered travellers congruent with your valid passport. After Swan Hellenic Travel has confirmed the trip, name changes are only permitted for a handling fee of €/GBP/USD/AUD 50.00 per person. Name changes on scheduled flights are only possible in exceptional cases and on request; Swan Hellenic Travel charges a name change fee in line with the conditions of carriage of and requested by the single airlines per person after the issue of the ticket. Depending on the availability of the airfields, additional surcharges may apply. Pure name corrections in case of incorrect spelling are free of charge. The customer will be charged EUR/GBP/USD/AUD 100.00 for rebookings and changes as well as fees charged by third parties (airlines fees excluded – see above). The advertised conditions apply to rebookings and new bookings; discounts and special conditions for the trip to be rebooked cannot be transferred.
- 5.2 Irrespective of this, each customer is free to withdraw from the originally booked trip under the cancellation conditions under item 4.3 and to book a new trip. This is mandatory for each rebooking request 60 days or later to departure date.

#### 6. SERVICES NOT USED

If the traveller does not make use of individual travel services which have been duly offered to him for reasons attributable to him (e.g. early return or other compelling reasons), he shall not be entitled to pro rata reimbursement of the travel price. Swan Hellenic Travel will endeavour to have the saved expenses reimbursed by the service providers. This obligation shall not apply if the services concerned are completely insignificant or if reimbursement is contrary to statutory or official provisions.

#### 7. TERMINATION FOR REASONS OF CONDUCT OR UNAVOIDABLE, EXTRAORDINARY CIRCUMSTANCES

Swan Hellenic Travel may terminate the Travel Contract without notice if the Traveller

- a) he has not notified any unfitness to travel known to him before the start of the journey;
- b) knowingly misstated his age;
- c) is, in the judgement of the master or the ship's doctor, incapable of travelling because of illness, infirmity or any other cause i.e. pandemic suspect;
- d) is dependent on company, but travels unaccompanied;
- e) the performance of a voyage, notwithstanding a warning from Swan Hellenic Travel or the ship's management, causes lasting disruption or behaves in a manner contrary to the contract to such an extent that the immediate cancellation of the contract is justified;
- f) booked with false personal or nationality details;
- g) does not appear at the start of the journey within the check-in periods provided, or does not comply with the necessary travel regulations or does not carry the necessary travel documents, so that there is a risk that other passengers may not leave the ship for shore leave.
- h) carries weapons, ammunition, explosive or flammable substances and the like,
- i) consumes or carries drugs or commits criminal offences while travelling. A justified termination also exists in the case of an attempt of the aforementioned actions h) and i).
- j) is on corresponding anti-terror lists of the EU or OFAC.

If Swan Hellenic Travel terminates the contract, Swan Hellenic Travel retains the right to the travel price; however, Swan Hellenic Travel must allow itself to be credited with the value of the saved expenses as well as those benefits which Swan Hellenic Travel obtains from another use of the service not used, including the amounts credited to Swan Hellenic Travel by the service providers.

If Swan Hellenic Travel is prevented from carrying out and fulfilling the cruise package contract prior to commencement of travel due to unavoidable, extraordinary circumstances, Swan Hellenic Travel may declare its withdrawal from the contract to the customer immediately after becoming aware of the reason for withdrawal. Swan Hellenic Travel will then refund the paid travel price within 14 days. Swan Hellenic Travel reserves the right to demand reasonable compensation for travel services rendered or to be rendered.

On board there is an on-board regulation which must be observed and observed by the customer without restriction. The captain is responsible for the ship, the passengers and the crew. Within the framework of the seamanly conduct of the ship, the guarantee of safety, as well as with regard to the observance of the ship rules, the captain has the sole decision-making



authority and is thus entitled to expel customers from the ship without compensation.

## 8. WARRANTY / COOPERATION OBLIGATIONS OF THE TRAVELLER

### 8.1 Notification of defects;

If the trip is not carried out in accordance with the contract, the traveller can demand remedy. To the extent that Swan Hellenic Travel was unable to remedy the defect due to a culpable omission of the notice of defects, the Traveller may neither assert claims for a reduction of the purchase price pursuant to EU Package Travel Directive in the Cyprus transition or the respective national law statutes, in your country where the travel modules are offered, nor claims for damages pursuant to damage of tort definition or the respective national law statutes, in your country where the travel modules are offered. Insofar as the notice of defects is not recognisably futile or unreasonable for other reasons, the traveller can immediately notify the cruise package guide at the holiday destination of this or on board the vessel. If a cruise package guide is not available on site, the customer may notify Swan Hellenic Travel of any travel defects at its registered office. The customer will be informed about the availability of the cruise package guide or of Swan Hellenic Travel in the service description, at the latest, however, with the travel documents. The cruise package guide shall be instructed to remedy the situation as far as this is possible. However, he is not authorized to recognize claims of the traveller. The customer can demand a reduction of the travel price corresponding to the reduced performance (i.e. regarding the Cyprus transition or the respective national law statutes, in the country where the travel modules are offered) if, despite his request for remedy (see 8.1), travel services or substitute services accepted by him were not provided in accordance with the contract.

### 8.2 Deadline prior to termination;

If a customer wishes to terminate the travel contract in accordance with EU Package Travel Directive in the Cyprus transition or the respective national law statutes, in your country where the travel modules are offered, due to a significant deficiency in travel as described in EU Package Travel Directive in the Cyprus transition or the respective national law statutes, in the country where the travel modules are offered, insofar as it is substantial, he must first set Swan Hellenic Travel a reasonable deadline for remedial action. This only does not apply if remedy is refused by Swan Hellenic Travel or if immediate remedy is necessary. If the cruise package is then significantly impaired as a result of the non-contractual provision of services, the customer may terminate the package cruise package contract. If the contract is cancelled thereafter, the customer shall retain the right to repatriation if the contract included repatriation. Swan Hellenic Travel shall bear the additional costs of the return transport. Cases of unforeseeable, extraordinary circumstances which do not affect any travel services provided by Swan Hellenic Travel do not entitle the customer to withdraw from the package travel contract free of charge.

The customer's request for remedy may also be addressed directly to Swan Hellenic Travel: Swan Hellenic Travel Ltd. [www.swanhellenic.com](http://www.swanhellenic.com), Phone +49 (0)211 1386 6123, E-mail: [support@SwanHellenic.com](mailto:support@SwanHellenic.com)

Authorised recipient and representative: Swan Hellenic Travel Ltd. UK Branch: 60 Petty France, London, SW1H 9EU

Swan Hellenic Travel Ltd. German Branch: Koenigsallee 14, Dusseldorf, 40212

The customer must note that in the case of reports to his travel agent outside his opening hours, a direct transfer to Swan Hellenic Travel for the speedy processing of the remedy request is not guaranteed.

If Swan Hellenic Travel culpably violates obligations arising from the package travel contract, Swan Hellenic Travel shall be obliged to compensate the customer for the resulting damage (based on EU package Travel Directive in the Cyprus transition or the respective national law statutes, in the country where the travel modules are offered). If the journey is thwarted or considerably impaired as a result, the customer may, if he has demanded unsuccessful remedy (see 8.1.), also demand reasonable compensation in money for the useless holiday time spent. 8.3 Loss of baggage, damage to baggage and delay of baggage, Swan Hellenic Travel strongly recommends that damage or delays in delivery during air travel be reported immediately to the responsible airline at the airport by means of a Property Irregularity Report (P.I.R.). Airlines usually refuse refunds if the damage report has not been completed. In case of damage to luggage, the damage report must be submitted within seven days and in case of delay within 21 days of delivery. Otherwise, the loss, damage or misrouting of baggage must be reported to the cruise package guide or the local representative of Swan Hellenic Travel. Damage to or loss of luggage during embarkation or disembarkation must be reported immediately. The customer is obliged to notify Swan Hellenic Travel or its agents in writing. If cabin baggage is visibly damaged, the customer must notify Swan Hellenic Travel of the damage immediately, at the latest, however, at the time of disembarkation. In the case of other, externally recognizably damaged luggage, which has been transported by the on-board personnel or stored for the customer, the customer must report the damage as soon as it is handed back to him. If the damage is not externally visible, the report must be made no later than 15 days after disembarkation, handover or the time at which handover was scheduled. The carriage, stowage and handling of the passenger's own luggage on board shall always be at the passenger's own risk. Cabin luggage damage is limited to a maximum liability amount of 2,250 units of account (unit of account is the special drawing right of the International Monetary Fund). The amount shall be converted into Euro/GBP/USD/AUD according to the value of the Euro/GBP/USD/AUD in relation to the Special Drawing Right, per customer and per trip, insofar as damage was neither intentionally nor grossly negligently caused by Swan Hellenic Travel. The limitation of liability shall also apply insofar as Swan Hellenic Travel is responsible for any damage incurred by the customer solely due to the fault of a service provider. In the event of loss of or damage to mobility equipment or other special equipment used by a passenger with reduced mobility, Swan Hellenic Travel shall reimburse the replacement value of the equipment concerned or, if applicable, the repair costs. (i.e. implementation of the EU Regulation 392/2009 or the respective national law statutes, in your country where the travel modules are offered).

## 9. LIMITATION OF LIABILITY

- 9.1 The contractual liability of Swan Hellenic Travel for damages that do not result from injury to life, body or health (including liability for injury before, – in addition to, – or after contractual obligations) is limited to three times the cruise package price, in so far as damage to the customer is caused neither intentionally nor by gross negligence or in so far as Swan Hellenic Travel is responsible for any damage incurred by the customer solely due to the fault of a service provider. Any further claims based on international agreements shall remain unaffected by this limitation of liability.

For all claims for damages against Swan Hellenic Travel based on tort, which are not based on intent or gross negligence, the liability for property damage is limited to three times the travel price. These maximum liability sums apply per customer and trip.

Any further claims based on international agreements shall remain unaffected by this limitation of liability.

- 9.2 If Swan Hellenic Travel is appointed as a contractual shipowner, liability shall be governed by the special international conventions or statutory provisions based on such conventions. Carriage by sea is subject to the liability provisions of the Athens Convention 1974 and the Protocol thereto 2002 as well as the IMO Reservation and the IMO Guidelines for the Implementation of the Athens Convention, which have been implemented in the European Community by Directive 392/2009 for the Carriage of Passengers by Sea. The exact limits of liability can be found here. The provisions of this paragraph shall not apply only if the provisions referred to in point 9.1 lead to a lesser claim on Swan Hellenic Travel. In this context, Swan Hellenic Travel draws attention to the following points in connection with the liability provisions for sea transport:

The liability of Swan Hellenic Travel for the loss of and damage to luggage, mobility aids and other special medical equipment used by customers and/or their fellow passengers with reduced mobility is excluded if the customer and/or fellow passenger does not notify Swan Hellenic Travel of the damage at the latest at the time of disembarkation or at the latest 15 days after disembarkation in the case of damage which is not recognisable. A written notification is not required if both parties have already jointly determined the damage within the period.

- c) Swan Hellenic Travel is not liable for damage to or loss of personal equipment or valuables (e.g. money, important documents, precious stones, jewellery, works of art, dentures, photo and film cameras, smartphones, notebooks and tablet PCs including accessories, etc.) due to theft, other loss or other extreme influences, which are not attributable to intentional or grossly negligent conduct on the part of Swan Hellenic Travel, unless they were deposited for safekeeping during transport, e.g. in the reception safe.
- 9.3 Swan Hellenic Travel is expressly not liable for service disruptions, personal injury and material damage in connection with services which are merely brokered as third-party services (e.g. excursions, sports events, visits to the theatre, exhibitions, transport services to and from the advertised place of departure and destination), all third-party services are clearly and identifiably marked as such and are therefore not part of the travel service to be provided by Swan Hellenic Travel within the scope of the travel contract.
- 9.4 Swan Hellenic Travel has compiled an extensive shore excursion programme for the customer which in some illustrated cases is offered exclusively by carefully selected local organisers of the respective destination (port). Swan Hellenic Travel is only responsible for arranging these shore excursions, which are not organised, monitored or controlled by Swan Hellenic Travel. The shore excursion programme is provided by local tour operators who work independently of Swan Hellenic Travel. Organizers of shore excursions plan these in accordance with the lay times of the ship. Swan Hellenic Travel carries out the mediation of such external services as a pure service for the customer, but Swan Hellenic Travel is liable for errors in the mediation.
- 9.5 Air carriage owed as part of a cruise package is subject to the liability provisions of the Montreal Convention of 1999, as amended by Regulation (EC) No 779/2002.
- 9.6 Swan Hellenic Travel recommends that customers take out travel accident and luggage insurance in their own interest.
10. LIMITATION PERIOD – INFORMATION ON CONSUMER DISPUTE SETTLEMENT
- 10.1 All contractual claims of the customer shall become statute-barred after two years. The claims for damages under maritime law due to death, damage to body or luggage become statute-barred after two years. Claims arising from tort shall become statute-barred within three years unless they also arise under the provisions of the Cyprus Commercial Code on maritime liability.
- 10.2 The limitation period begins on the day on which the trip should end according to the contract. If the last day of the period falls on a Sunday, a public holiday recognised by the state at the place of declaration or a Saturday, the next working day shall take the place of such a day.
- 10.3 If negotiations between the customer and Swan Hellenic Travel concerning the claim or the circumstances justifying the claim are pending, the statute of limitations shall be suspended until the customer or Swan Hellenic Travel refuses to continue the negotiations. The limitation period shall commence at the earliest three months after the end of the suspension.
- 10.4 Swan Hellenic Travel operates a modern, fast and fair complaints management system. This is attainable for its customers under support@SwanHellenic.com. Swan Hellenic Travel does not take part in a consumer dispute settlement. If a consumer dispute resolution would become obligatory for Swan Hellenic Travel after printing of these trading conditions, Swan Hellenic Travel informs the consumers about it in suitable form. Swan Hellenic Travel refers to the European Online Dispute Resolution Platform for all contracts concluded in electronic legal transactions.

## 11. OBLIGATIONS TO PROVIDE INFORMATION ON THE IDENTITY OF THE CARRIER UNDERTAKING PERFORMING THE CONTRACT

The EU regulation on informing passengers of the identity of the operating airline obliges Swan Hellenic Travel to inform the customer of the identity of the operating airline of all air transport services to be provided within the scope of the booked journey at the time of booking. If the operating

airline has not yet been determined at the time of booking, Swan Hellenic Travel is obliged to inform the customer of the airline or airlines that will probably operate the flight. As soon as Swan Hellenic Travel knows which airline will operate the flight, Swan Hellenic Travel will inform the customer. If the airline named to the customer as the operating airline changes, Swan Hellenic Travel will inform the customer of the change. Swan Hellenic Travel will immediately take all reasonable steps to ensure that the customer is informed of the change as soon as possible. The list of airlines banned from EU operations is available on the following website: [http://ec.europa.eu/transport/modes/air/safety/air-ban/index\\_de.htm](http://ec.europa.eu/transport/modes/air/safety/air-ban/index_de.htm)

## 12. PASSPORT, VISA AND HEALTH REQUIREMENTS

- 12.1 The customer shall be informed about the entry regulations in the cruise brochure, in the travel advertisement, or in the Internet presence, in the online travel advertisements and in the "FAQ" in the travel catalogue or online, prior to the conclusion of the contract. He must observe the necessity of carrying valid identity documents, in particular a valid machine-readable passport (ePassport) and its period of validity. As a general rule, every passenger must carry a valid passport on the respective trip, which must be valid for at least 6 months after the end of the trip. On all journeys which exclusively call at ports in the EU as well as in Norway and Iceland, Schengen area citizens only require an identity card which is valid for at least 6 months after the end of the journey. All children require a children's passport for all trips to ports in the EU, Norway and Iceland up to the age of 14, otherwise a machine-readable passport (ePassport) which is valid for at least 6 months after the end of the trip. The entry of the child in the passport of a parent or guardian is no longer sufficient.
- 12.2 Swan Hellenic Travel offers the trips in this travel catalogue or the corresponding website in all European EEA countries and worldwide, Swan Hellenic Travel will therefore inform its local customers about the provisions of passport, visa and health regulations for the respective travel countries of the cruise or trip prior to conclusion of the contract and about any changes to such provisions prior to commencement of the trip. This information can also be arranged by the mediating travel agency due to its own legal obligation (i.e. based on the Cyprus transition or the respective national law statutes, in the country where the travel modules are offered) and should be documented by this. Swan Hellenic Travel provides further information via its website and in the booking systems by accessing suitable databases.
- 12.3 The customer himself is responsible for retrieving the further information suitable for him until departure, obtaining and carrying the travel documents required by the authorities, any necessary vaccinations and compliance with customs and foreign exchange regulations. This is also valid for travel ban and special authorities request regarding pandemic suspect or sudden border closure for traveller from distinctive countries with a high pandemic risk level. Any disadvantages resulting from non-compliance with these regulations, e.g. the payment of withdrawal costs or official fines, shall be borne by the customer. This shall not apply if Swan Hellenic Travel or the travel agent has failed to provide adequate or incorrect information.
- 12.4 Swan Hellenic Travel shall not be liable for the timely issue and receipt of necessary visas by the respective diplomatic representation if the customer has commissioned Swan Hellenic Travel with the procurement, unless Swan Hellenic Travel has culpably breached its own obligations.

## 13. DATA PROTECTION / RIGHT TO OBJECT TO ADVERTISING

The personal data provided by the customer to Swan Hellenic Travel will be electronically processed, stored and used to the extent necessary for the execution of the contract, for the processing of the trip, for customer support or for the fulfilment of statutory provisions. In addition, if the customer has agreed to this, the data will be used for market research purposes and to send current information and offers. Swan Hellenic Travel processes the booking order on the basis of the GDPR, taking into account the applicable data protection regulations. The customer has the right to object to this further use of data at any time or to revoke the consent given for the aforementioned purposes at any time. For this purpose, the customer shall contact Swan Hellenic Travel, data protection officer, address Cyprus, by e-mail to [dpo@SwanHellenic.com](mailto:dpo@SwanHellenic.com) or by post to Swan Hellenic Travel. The customer can find more details in the Swan Hellenic Travel DATA PROTECTION DECLARATION.

## 14. CHOICE OF LAW / PLACE OF JURISDICTION / GENERAL CLAUSE

- 14.1 Unless otherwise stipulated for the benefit of the customer in regulations or international conventions which are mandatory for the travel contract, the entire contractual and legal relationship between Swan Hellenic Travel and the customer shall be governed exclusively by Cyprus law.
- 14.2 Complaints against Swan Hellenic Travel shall be brought before the competent local and factual courts for the registered office of Swan Hellenic Travel Ltd. – Cyprus, unless mandatory statutory provisions or international agreements stipulate otherwise.
- 14.3 The place of jurisdiction for actions brought by Swan Hellenic Travel against customers or contractual partners of the travel contract who are merchants, legal entities under public or private law or persons who have their place of residence or habitual abode abroad, or whose place of residence or habitual abode is unknown at the time the action is brought, shall be the registered office of Swan Hellenic Travel in Nicosia – Cyprus.
- 14.4 The invalidity of individual provisions of the travel contract and/or these travel conditions shall not result in the invalidity of the entire travel contract or the entire travel conditions.

## TOUR OPERATOR:

Tour Operator: Swan Hellenic Travel Ltd.: Themistokli Dervi 20, Flat/Office 301, 1066 Nicosia, Cyprus [www.SwanHellenic.com](http://www.SwanHellenic.com)

Authorised recipient and representative:

Swan Hellenic Travel Ltd. UK Branch: 60 Petty France, London, SW1H 9EU  
[support@SwanHellenic.com](mailto:support@SwanHellenic.com)

Swan Hellenic Travel Ltd. German Branch: Koenigallee 14, Dusseldorf, 40212  
[support@SwanHellenic.com](mailto:support@SwanHellenic.com)

Insolvency bonding:

For cruise packages ACTA: 24 Stasikratous Street, 1065 Nicosia, Cyprus

The main rights of customers/travellers under Directive (EU) 2015/2302 are set out below:

Form for informing the traveller of a cruise package in accordance with EU Package Travel Directive

The combination of travel services offered to you is a cruise package within the meaning of Directive (EU) 2015/2302.

You can therefore take advantage of all the EU rights that apply to package travel. Swan Hellenic Travel Ltd. is fully responsible for the proper execution of the entire package.

In addition, Swan Hellenic Travel Cruises Ltd. has the statutory security to repay your payments and, if the transport is included in the package, to secure your return transport in the event of its insolvency.

Main rights under Directive (EU) 2015/2302:

- Passengers will receive all essential information about the package prior to the conclusion of the package travel contract.
- At least one contractor is always liable for the proper provision of all travel services included in the contract.
- Travellers receive an emergency telephone number or contact details of a contact point where they can contact the tour operator or travel agency.
- Travellers may transfer the package to another person within a reasonable time and possibly at additional cost.
- The price of the package may only be increased if certain costs (e.g. fuel prices) increase and if this is expressly provided for in the contract, and in any event no later than 20 days before the package commences. If the price increase exceeds 8% of the package price, the traveller may withdraw from the contract. If a tour operator reserves the right to a price increase, the traveller has the right to a price reduction if the corresponding costs are reduced.
- Travellers may withdraw from the contract without paying a cancellation fee and will receive full reimbursement of all payments if any of the essential elements of the package other than the price is substantially changed. If the operator responsible for the package cancels the package before its commencement, travellers shall be entitled to reimbursement and, in certain circumstances, compensation.
- In exceptional circumstances, travellers may withdraw from the contract before the package starts without paying a cancellation fee, for example if there are serious safety problems at destination which are likely to affect the package.
- In addition, travellers may withdraw from the contract at any time before the start of the package against payment of a reasonable and justifiable cancellation fee.
- If after the start of the cruise package essential components of the cruise package cannot be carried out as agreed, the traveller shall be offered appropriate other precautions at no additional cost. The traveller can withdraw from the contract without paying a cancellation fee (in the Federal Republic of Germany this right is called "termination") if services are not provided in accordance with the contract and this has considerable effects on the provision of the contractual cruise package services and the tour operator fails to remedy the situation.
- The traveller is entitled to a price reduction and/or compensation if the travel services are not provided or not provided properly.
- The tour operator will assist the traveller if he is in difficulties. In the event of the insolvency of the tour operator or, in some Member States, of the travel agent, payments will be refunded. If the insolvency of the tour operator or, if relevant, of the travel agent occurs after the package has commenced and the carriage forms part of the package, the return of the passengers shall be guaranteed. Swan Hellenic Travel Ltd. has concluded insolvency bonding with ACTA: 24 Stasikratous Street, 11065 Nicosia, Cyprus



# Where to find us?

## Australia

Suite 14b, Level 1, 123 Clarence St,  
Sydney NSW, 2000

*AU enquiries-au@swanhellenic.com*

*NZ enquiries-nz@swanhellenic.com*

*AU +61 1300 722 499*

*NZ +64 800 004 649*

## Cyprus

24, Grigoriou Xenopoulou, office 102,  
1061, Nicosia, Cyprus

*office@swanhellenic.com*

*+35722667727*

## Denmark

Swan Hellenic

C/O Nordic CruiseGsa ApS, Traverbanevej 10,  
2920, Charlottenlund, Denmark

*enquiries-dk@swanhellenic.com*

*+4520200400*

## Germany

Koenigsallee 14,  
40212 Düsseldorf

*enquiries-de@swanhellenic.com*

*+49 211 13 866 123*

## Hong Kong

Suite 1201A, 12/F, Tower 1,  
Admiralty Centre, 18 Harcourt Road,  
Hong Kong

*enquiries@swanhellenic.asia*

*+852 286 10300*

## India

Wellesley House 7, Red Cross Place,  
Kolkata 700 001, India

*enquiries-ind@swanhellenic.com*

*+91 98676 24569*

## UK

Office 1403, 20 Brock Street,  
Regents Place, London, NW1 3DS

*enquiries@swanhellenic.com*

*+44 2078460271*

## USA

1800 SE 10th Ave, Suite 240,  
Ft. Lauderdale, FL 33316

*inquiries@swanhellenic.com*

*1-800-537-6777*

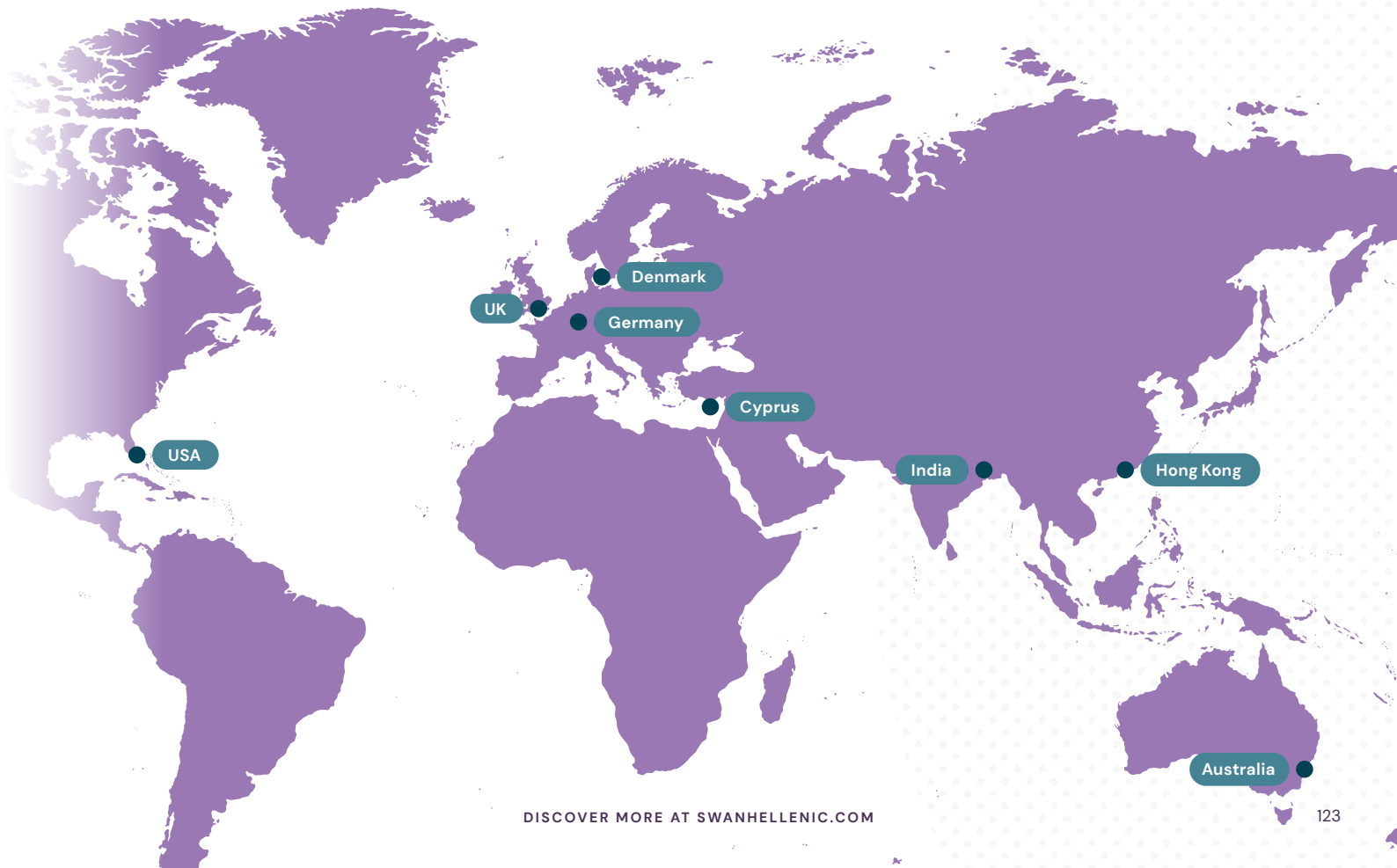



[www.ssstravel.de](http://www.ssstravel.de)  
Trogerstr. 40 81675 München  
Tel.089/472820 [info@ssstravel.de](mailto:info@ssstravel.de)



[SWANHELLENIC.COM](http://SWANHELLENIC.COM)